



# **PART 3.156 – R-117 ZONE, R-117 MULTIPLE DWELLING (1042 RICHARDSON STREET) DISTRICT**

## **3.156.1 Permitted Uses in this Zone**

The following uses are the only uses permitted in this Zone:

- a. Multiple dwelling
- b. Attached dwelling subject to the regulations in the R-K Zone
- c. Home occupation subject to the regulations in Schedule “D”
- d. Accessory Buildings subject to the regulations in Schedule “F”

## **3.156.2 Lot Area**

- a. Lot area (minimum) 668m<sup>2</sup>
- b. Lot width (minimum) 18.28m

## **3.156.3 Floor Space Ratio**

- a. Floor space ratio (maximum) 1.76:1

## **3.156.4 Height, Storeys**

- a. Principal building height (maximum) 18.5m
- b. Storeys (maximum) 6

## **3.156.5 Setbacks, Projections**

- a. Front yard setback (minimum) 4.0m
- b. Rear yard setback (minimum) 10m
- c. Side yard setback (minimum) 6m

## **3.156.6 Site Coverage, Open Site Space**

- a. Site Coverage (maximum) 40%
- b. Open site space (minimum) 50%

**PART 3.156 – R-117 ZONE, R-117 MULTIPLE DWELLING (1042 RICHARDSON STREET) DISTRICT**

**3.156.7 Vehicle and Bicycle Parking**

- |                                     |  |
|-------------------------------------|--|
| a. <u>Vehicle parking</u> (minimum) | Subject to the regulations in Schedule “C” |
| b. Bicycle parking (minimum)        | Subject to the regulations in Schedule “C” |

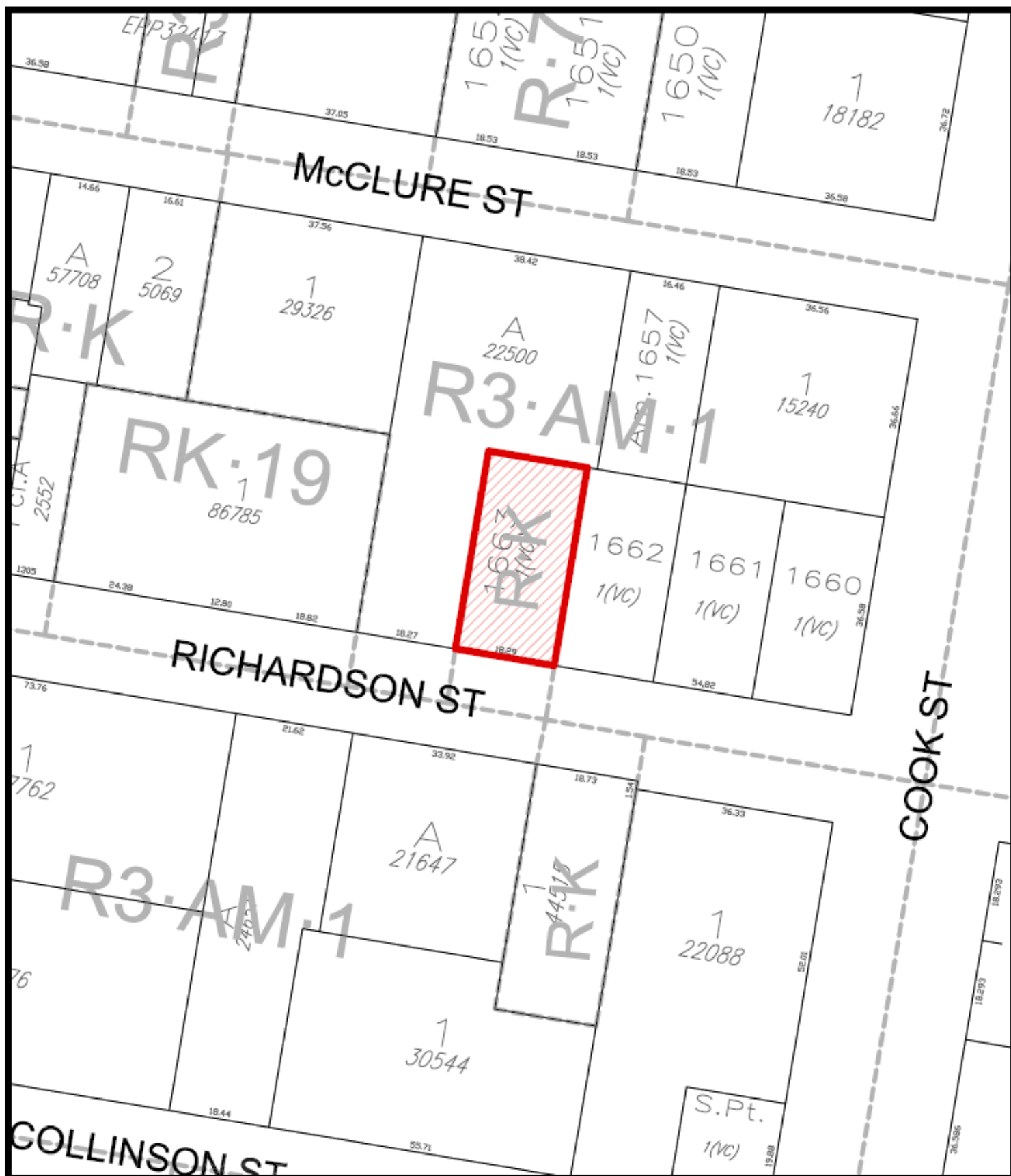

1042-1044 Richardson Street  
Rezoning No.00753

