

2 EXISTING PARKING AREA PLAN  
Scale: 1:100

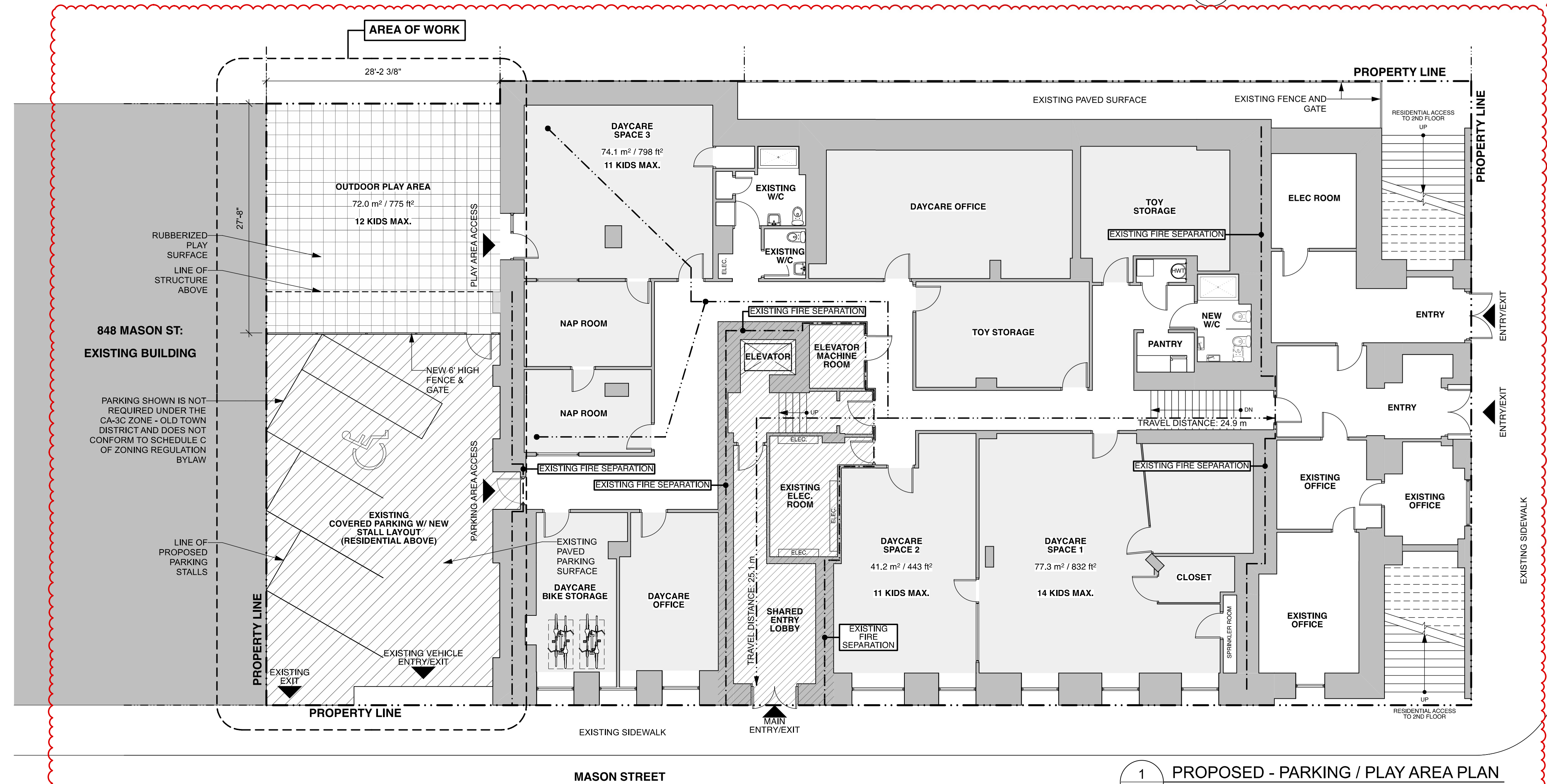

1 PROPOSED - PARKING / PLAY AREA PLAN  
Scale: 1:100

**Revisions**  
Bubble areas indicate revisions compared to the previously submitted plans  
**Received Date**  
March 18, 2026

SYMBOL LEGEND	
	ASSEMBLY TAG
	WINDOW TAG
	DOOR TAG
	KEY NOTES TAG
	MATERIAL TAG
	DETAIL MARKER
	BUILDING SECTION MARKER
	SECTION DETAIL MARKER
	ELEVATION MARKER
	FIRE SEPARATION FIRE RESISTANCE RATING (TIME)
	FIRE SEPARATION INDICATOR
LANDSCAPING LEGEND	
	EXISTING BUILDING
	EXISTING UNCOVERED PARKING/PAVED SURFACE
	EXISTING COVERED PARKING/PAVED SURFACE
	PROPOSED RUBBERIZED TILE PLAY SURFACE

**R2 REVISION 2**

- EXISTING AND PROPOSED FLOOR PLANS SHOWN DEMONSTRATING TRAVEL DISTANCE TO EXITS
- CANVAS AWNINGS REMOVED FROM PROPOSED OUTDOOR PLAY AREA
- OCCUPANT LOAD BREAKDOWN OF CHILDREN TO CARE GIVERS ADDED TO PROJECT DATA
- NOTE REGARDING PROPOSED PARKING STALLS ADDED

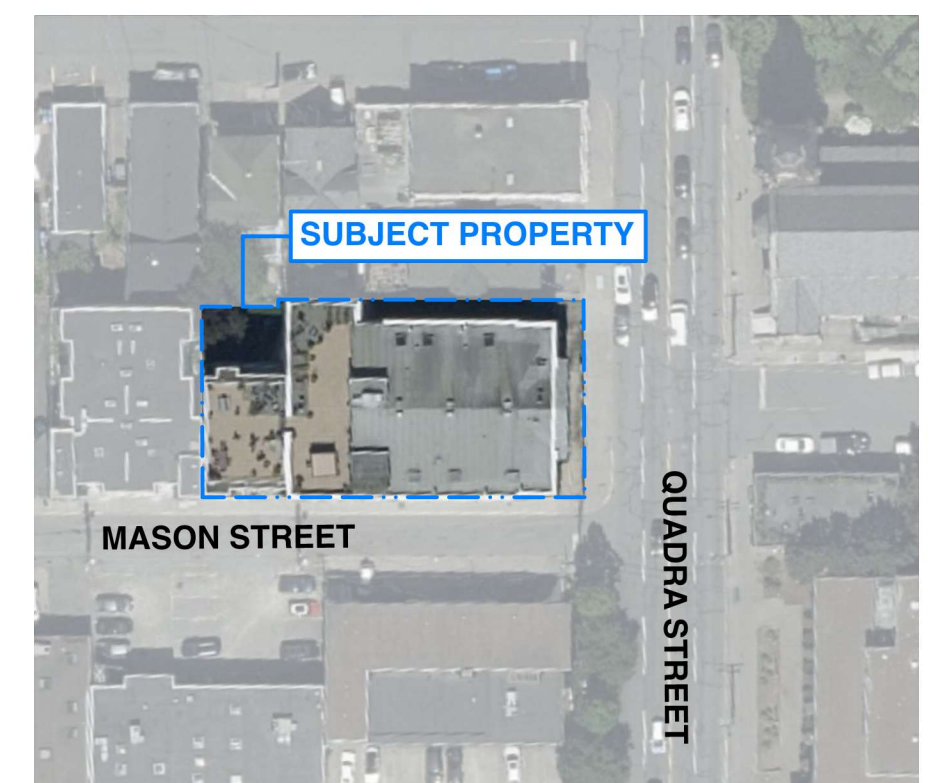
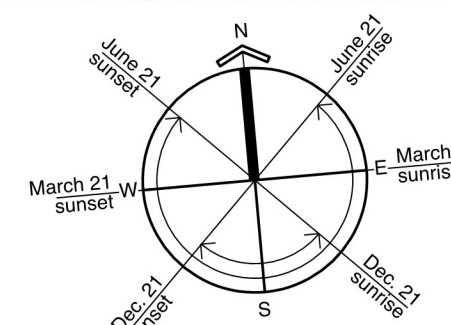

6 AERIAL  
Scale: N.T.S.

PROJECT DATA	
<b>LEGAL DESCRIPTION:</b> PROPERTY ID 160927, LOT 1 VIS 6626, SL, STRATA, VICTORIA	
<b>LOT AREA:</b> 0.1010 hectare / 0.25 acres / 1010.2 m <sup>2</sup>	
<b>ZONING:</b> CA-3C OLD TOWN DISTRICT	
<b>SUITE OCCUPANCY:</b> GROUP A, DIVISION 2 - DAYCARE FACILITIES FOR CHILDREN	
<b>CURRENT BUILDING USE:</b> VACANT OFFICE SPACE AND RESIDENTIAL UNITS ABOVE	
<b>PROPOSED BUILDING USE:</b> DAYCARE/OFFICES AND RESIDENTIAL UNITS ABOVE	
<b>BUILDING AREA:</b> 900.4 m <sup>2</sup> (9692 ft <sup>2</sup> )	
<b>DAYCARE SPACE AREAS:</b>	
- DAYCARE SPACE 1:	77.3 m <sup>2</sup> (832 ft <sup>2</sup> )
- DAYCARE SPACE 2:	41.2 m <sup>2</sup> (443 ft <sup>2</sup> )
- DAYCARE SPACE 3:	74.1 m <sup>2</sup> (798 ft <sup>2</sup> )
- TOTAL DAYCARE SPACE AREA:	192.6 m <sup>2</sup> (2073 ft <sup>2</sup> )
<b>DAYCARE OUTDOOR SPACE AREAS:</b>	
- TOTAL OUTDOOR SPACE:	72.0 m <sup>2</sup> (775 ft <sup>2</sup> )
<b>OCCUPANT LOAD:</b>	
- DAYCARE:	
- DAYCARE SPACE 1: 14 CHILDREN + 4 STAFF	
- DAYCARE SPACE 2: 11 CHILDREN + 2 STAFF	
- DAYCARE SPACE 3: 11 CHILDREN + 2 STAFF	
- TOTAL: 36 CHILDREN + 8 STAFF	
<b>WASHROOMS:</b>	
- WASHROOMS REQUIRED:	
- DAYCARE: (1 W/C PER 10 CHILDREN) 3.6 = 4	
- WASHROOMS PROVIDED:	
- 4 GENDER NEUTRAL WASHROOMS	
<b>PARKING:</b>	
- EXISTING: 5 STALLS (4 REGULAR STALLS + 1 ACC. STALL)	
- PROPOSED: 3 STALLS (2 REGULAR STALLS + 1 ACC. STALLS)	

**FINLAYSON BONET ARCHITECTURE LTD.**

#4 - 7855 East Saanich Rd. Saanichton V8M 2B4  
Phone: 250-656-2224 Fax: 250-656-2279 Email: info@finlaysonbonet.ca

REGISTERED ARCHITECT  
BRITISH COLUMBIA  
2008.03.20

12Mar26 DDP Application Rev. 2  
02Feb26 DDP Application Rev. 1  
01Jan26 Issued for DDP

Rev Date Description  
Checked By SMB  
Drawn By GRK  
Scale AS NOTED  
Date

MARCH 12, 2026

Project Name  
**BUBBY'S EARLY LEARNING CHILD CARE**  
1600 QUADRA ST. VICTORIA, BC, V8W 2L4

Drawing Title  
**PARKING AREA PLAN - EXISTING & PROPOSED**

Drawing No.  
**A1.00R2**

Project No.  
**25011**

© Copyright reserved. These plans and designs are and at all times remain the property of Finlayson Bonet Architecture Ltd. to be used for the project shown and may not be reproduced without written consent.