

REISSUED FOR DEVELOPMENT PERMIT  
DECEMBER 12TH 2025

Victoria Porsche  
for Gain Group

Civic Address: 202 Harbour Road, Victoria, BC, V9A 3S2

CONSULTANT TEAM

OWNER: Gain Group  
LANDSCAPE: ETA Landscape Architecture  
ARCHITECT: Union Architecture  
STRUCTURAL: \*\*\*  
MECHANICAL: \*\*\*  
ELECTRICAL: \*\*\*  
CIVIL: J.E. Anderson and Associates

Sheet Drawing Title

- L0.0 Cover Sheet
- L0.1 Landscape Notes & Schedules
- L0.2 Landscape Illustrative Plan
- L0.3 Landscape Precedent Images
- L2.0 Offsite Plan
- L3.0 Landscape Materials Plan - Ground Level
- L3.1 Landscape Materials Plan - Upper Levels
- L4.0 Lighting Plan - Ground Level
- L5.0 Landscape Grading & Drainage Plan - Ground Level
- L6.0 Tree Plan - Ground Level
- L6.1 Offsite Planting Plan
- L6.2 Planting Plan - Ground Level
- L7.0 Soil Depth & Servicing Plan - Ground Level
- L7.1 Soil Depth & Servicing Plan -Upper Levels
- L9.1 Softscape Details
- L9.2 Softscape Details
- L9.3 Hardscape Details
- L9.4 Landscape Site Furnishing Details
- L9.5C Landscape Site Furnishing Details

Revision		
No.	Date	Revision Notes

Issue		
No.	Date	Issue Notes
A	2025-06-11	Issued for DP Draft
B	2025-07-11	Issued for DP
C	2025-12-11	Reissued for DP

Professional Seal

Project

Victoria Porsche

202 Harbour Rd, Victoria, BC, V9A 3S2

Drawing Title

Cover Sheet

Legal

Project Manager	Project ID
Project Manager	#####
Drawn By	Scale
Drawn By	NTS
Reviewed By	Drawing No.
Reviewed By	
	L0.0
	1 of 30







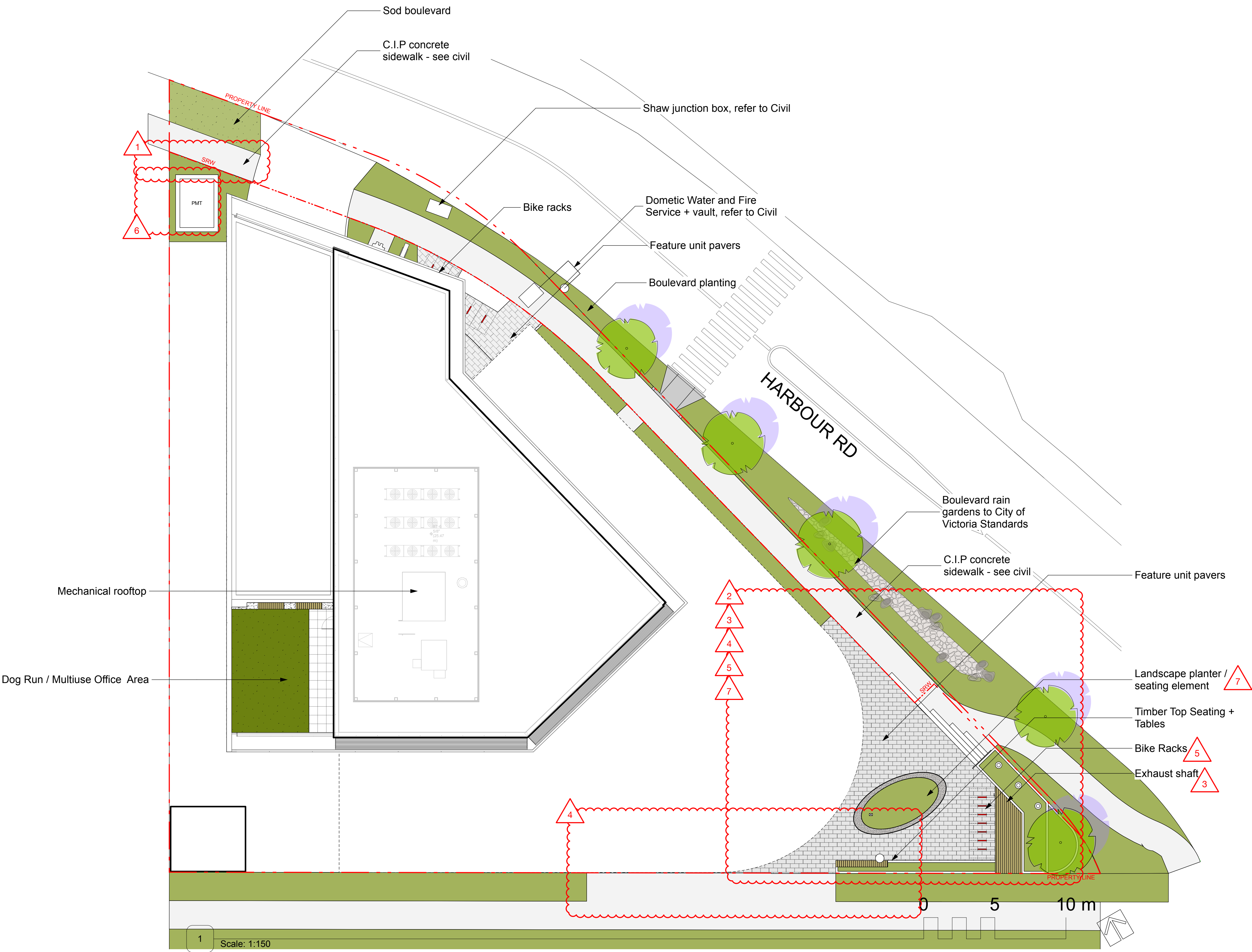

Revision		
No.	Date	Revision Notes

Issue		
No.	Date	Issue Notes
A	2025-06-11	Issued for DP Draft
B	2025-07-11	Issued for DP
C	2025-12-11	Reissued for DP

Professional Seal

**eta** landscape architecture

1690 West 2nd Avenue  
Vancouver , BC , Canada , V6J 1H4

t | 604.683.1456  
f | 604.683.1459  
w | www.etalala.ca

All Rights Reserved by eta landscape architecture inc.  
Information contained on these documents is part of the Consultant's instruments of service, and the Consultant shall retain ownership thereof. Such information shall not be used for any purpose other than for the construction of the referenced project. Any other use, reuse or modification of the documents without the Consultant's prior written consent will be at the recipient's sole risk and without liability or legal exposure to the Consultant.

Project

**Victoria Porsche**

202 Harbour Rd, Victoria, BC, V9A 3S2

Drawing Title

**Landscape  
Illustrative Plan**

Legal

Project Manager	Project ID
Project Manager	####
Drawn By	Scale
Drawn By	As Noted
Reviewed By	Drawing No.
Reviewed By	<b>L0.2</b>
	3 of 30





OFFSITE RAIN GARDENS



ONSITE VEHICLE DISPLAY



FEATURE PAVING



BUFFER PLANTING

Revision		
No.	Date	Revision Notes

Issue		
No.	Date	Issue Notes
A	2025-06-11	Issued for DP Draft
B	2025-07-11	Issued for DP
C	2025-12-11	Reissued for DP

Professional Seal

**eta** landscape architecture

1690 West 2nd Avenue  
Vancouver , BC , Canada , V6J 1H4

t | 604.683.1456  
f | 604.683.1459  
w | www.etalala.ca

All Rights Reserved by eta landscape architecture inc.  
Information contained on these documents is part of the Consultant's instruments of service, and the Consultant shall retain ownership thereof. Such information shall not be used for any purpose other than for the construction of the referenced project. Any other use, reuse or modification of the documents without the Consultant's prior written consent will be at the recipient's sole risk and without liability or legal exposure to the Consultant.

Project

**Victoria Porsche**

202 Harbour Rd, Victoria, BC, V9A 3S2

Drawing Title

**Landscape**

**Precedent Images**

Legal

Project Manager	Project ID
Project Manager	#####
Drawn By	Scale
Drawn By	As Noted
Reviewed By	Drawing No.
Reviewed By	<b>L0.3</b>
	4 of 30



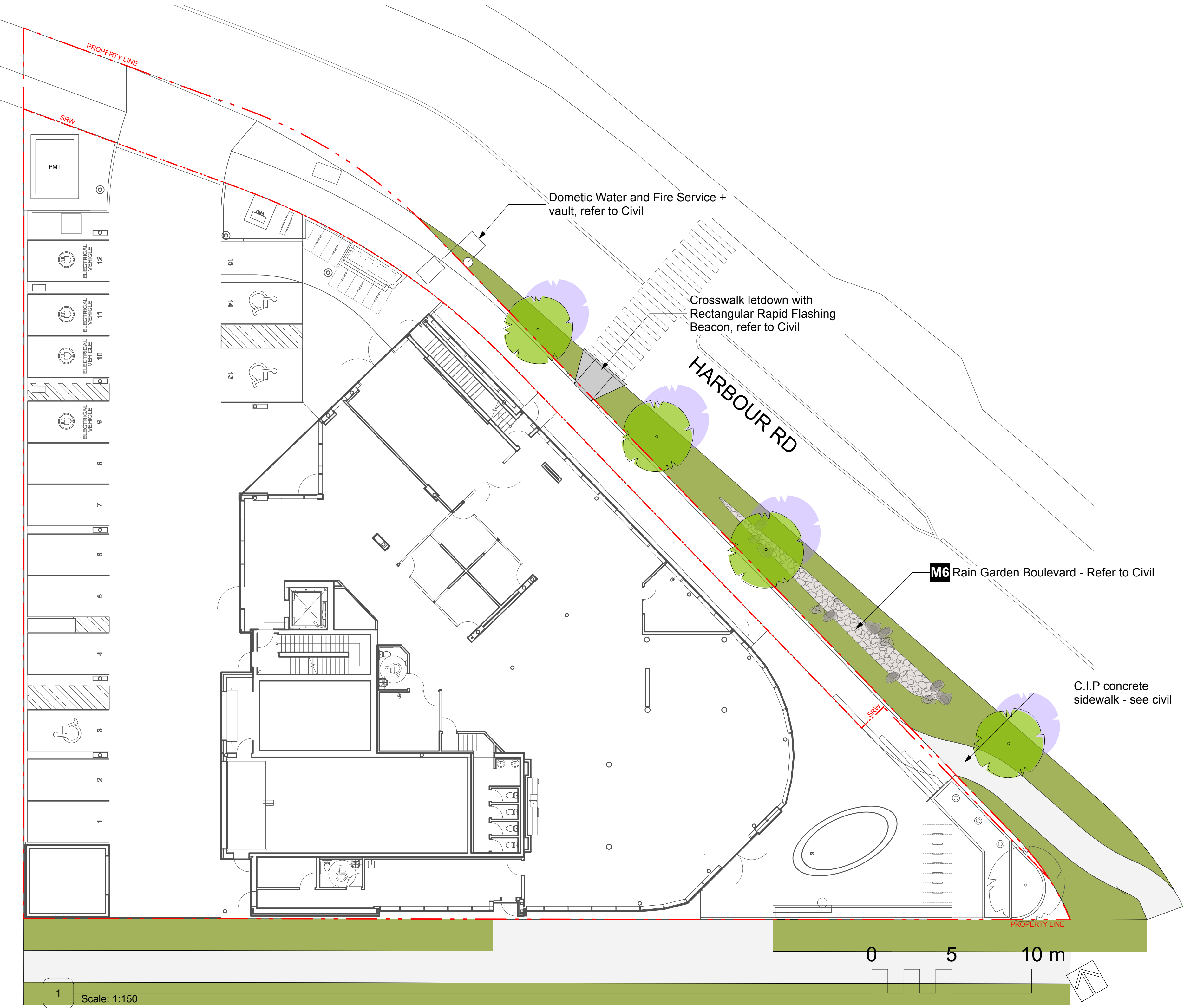

Revision		
No.	Date	Revision Notes

Issue		
No.	Date	Issue Notes
A	2025-06-11	Issued for DP Draft
B	2025-07-11	Issued for DP
C	2025-12-11	Reissued for DP

Professional Seal

**eta** landscape architecture

1690 West 2nd Avenue  
Vancouver , BC , Canada , V6J 1H4

t | 604.683.1456  
f | 604.683.1459  
w | www.etalala.ca

All Rights Reserved by eta landscape architecture inc.  
Information contained on these documents is part of the Consultant's instruments of service, and the Consultant shall retain ownership thereof. Such information shall not be used for any purpose other than for the construction of the referenced project. Any other use, reuse or modification of the documents without the Consultant's prior written consent will be at the recipient's sole risk and without liability or legal exposure to the Consultant.

Project

**Victoria Porsche**

202 Harbour Rd, Victoria, BC, V9A 3S2

Drawing Title

**Offsite Plan**

Legal

Project Manager	Project ID
Project Manager	####
Drawn By	Scale
Drawn By	As Noted
Reviewed By	Drawing No.
Reviewed By	<b>L2.0</b>
	6 of 30





Revision		
No.	Date	Revision Notes

Issue		
No.	Date	Issue Notes
A	2025-06-11	Issued for DP Draft
B	2025-07-11	Issued for DP
C	2025-12-11	Reissued for DP

Professional Seal

**eta** landscape architecture

1690 West 2nd Avenue  
Vancouver , BC , Canada , V6J 1H4

t | 604.683.1456  
f | 604.683.1459  
w | www.etal.ca

All Rights Reserved by eta landscape architecture inc.  
Information contained on these documents is part of the Consultant's instruments of service, and the Consultant shall retain ownership thereof. Such information shall not be used for any purpose other than for the construction of the referenced project. Any other use, reuse or modification of the documents without the Consultant's prior written consent will be at the recipient's sole risk and without liability or legal exposure to the Consultant.

Project

**Victoria Porsche**

202 Harbour Rd, Victoria, BC, V9A 3S2

Drawing Title

**Landscape  
Materials Plan -  
Ground Level**

Legal

Project Manager	Project ID
Project Manager	####
Drawn By	Scale
Drawn By	As Noted
Reviewed By	Drawing No.
Reviewed By	<b>L3.0</b>
	7 of 30



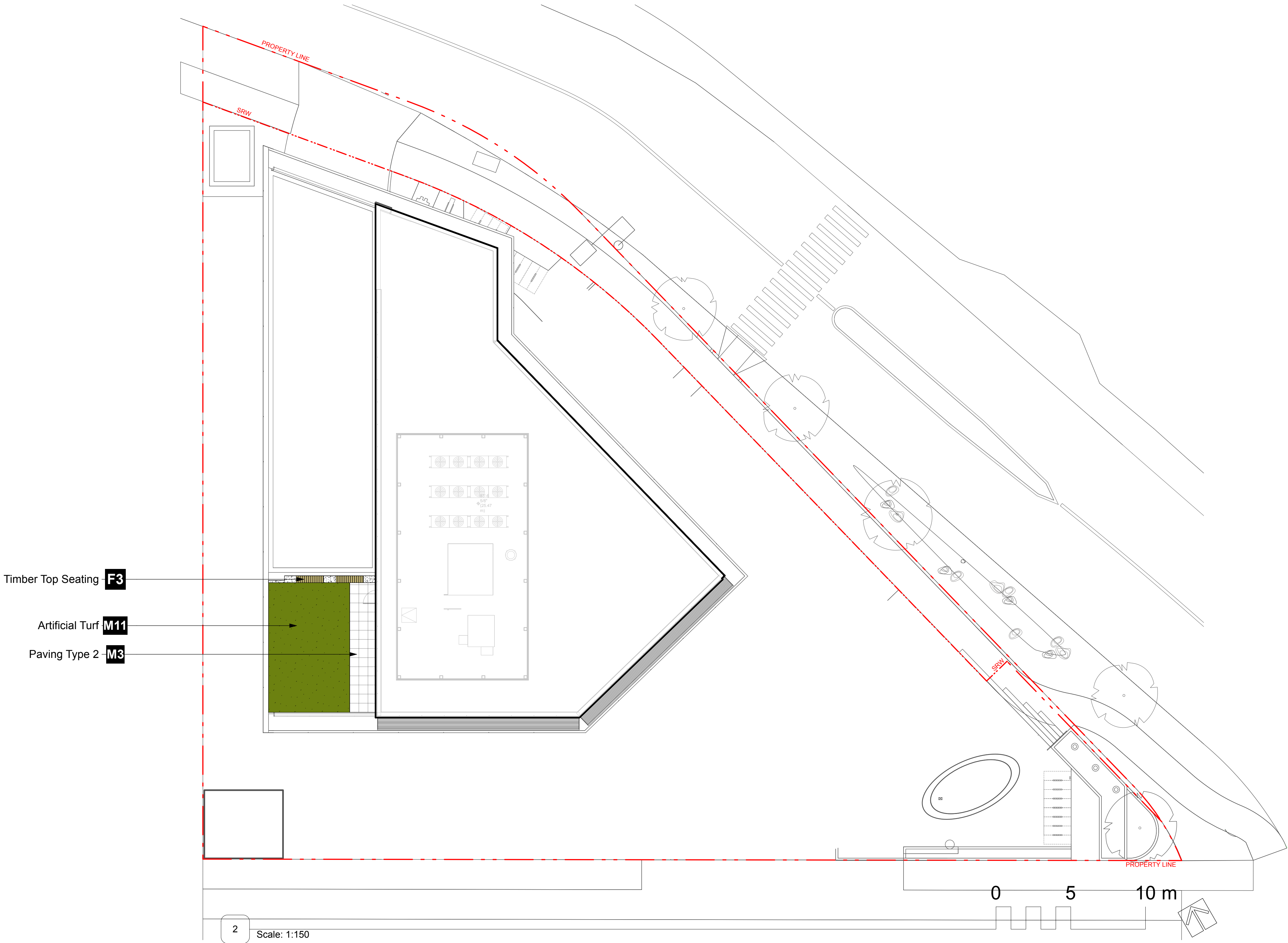

Revision		
No.	Date	Revision Notes

Issue		
No.	Date	Issue Notes
A	2025-06-11	Issued for DP Draft
B	2025-07-11	Issued for DP
C	2025-12-11	Reissued for DP

Professional Seal

**eta** landscape architecture

1690 West 2nd Avenue  
Vancouver , BC , Canada , V6J 1H4

t | 604.683.1456  
f | 604.683.1459  
w | www.etalala.ca

All Rights Reserved by eta landscape architecture inc.  
Information contained on these documents is part of the Consultant's instruments of service, and the Consultant shall retain ownership thereof. Such information shall not be used for any purpose other than for the construction of the referenced project. Any other use, reuse or modification of the documents without the Consultant's prior written consent will be at the recipient's sole risk and without liability or legal exposure to the Consultant.

Project

**Victoria Porsche**

202 Harbour Rd, Victoria, BC, V9A 3S2

Drawing Title

**Landscape  
Materials Plan -  
Upper Levels**

Legal

Project Manager	Project ID
Project Manager	####
Drawn By	Scale
Drawn By	As Noted
Reviewed By	Drawing No.
Reviewed By	<b>L3.1</b>
	8 of 30



Revision		
No.	Date	Revision Notes

Issue		
No.	Date	Issue Notes
A	2025-06-11	Issued for DP Draft
B	2025-07-11	Issued for DP
C	2025-12-11	Reissued for DP

Professional Seal

**eta** landscape architecture

1690 West 2nd Avenue  
Vancouver , BC , Canada , V6J 1H4

t | 604.683.1456  
f | 604.683.1459  
w | www.etalala.ca

All Rights Reserved by eta landscape architecture inc.  
Information contained on these documents is part of the Consultant's instruments of service, and the Consultant shall retain ownership thereof. Such information shall not be used for any purpose other than for the construction of the referenced project. Any other use, reuse or modification of the documents without the Consultant's prior written consent will be at the recipient's sole risk and without liability or legal exposure to the Consultant.

Project

**Victoria Porsche**

202 Harbour Rd, Victoria, BC, V9A 3S2

Drawing Title

**Lighting Plan -  
Ground Level**

Legal

Project Manager	Project ID
Project Manager	####
Drawn By	Scale
Drawn By	As Noted
Reviewed By	Drawing No.
Reviewed By	<b>L4.0</b>
	9 of 30

**LIGHTING PLAN LEGEND**

 S/W

Step / Wall Light

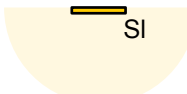
 SL

Strip Light

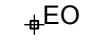
 EO

Electrical Outlet

Note:

1. Refer to Electrical plans & specs for final locations, fixture details and cut sheets.

2. Electrical outlets to be provided for each BBQ, Trellis, and Fire Table, if applicable. Refer to Electrical.

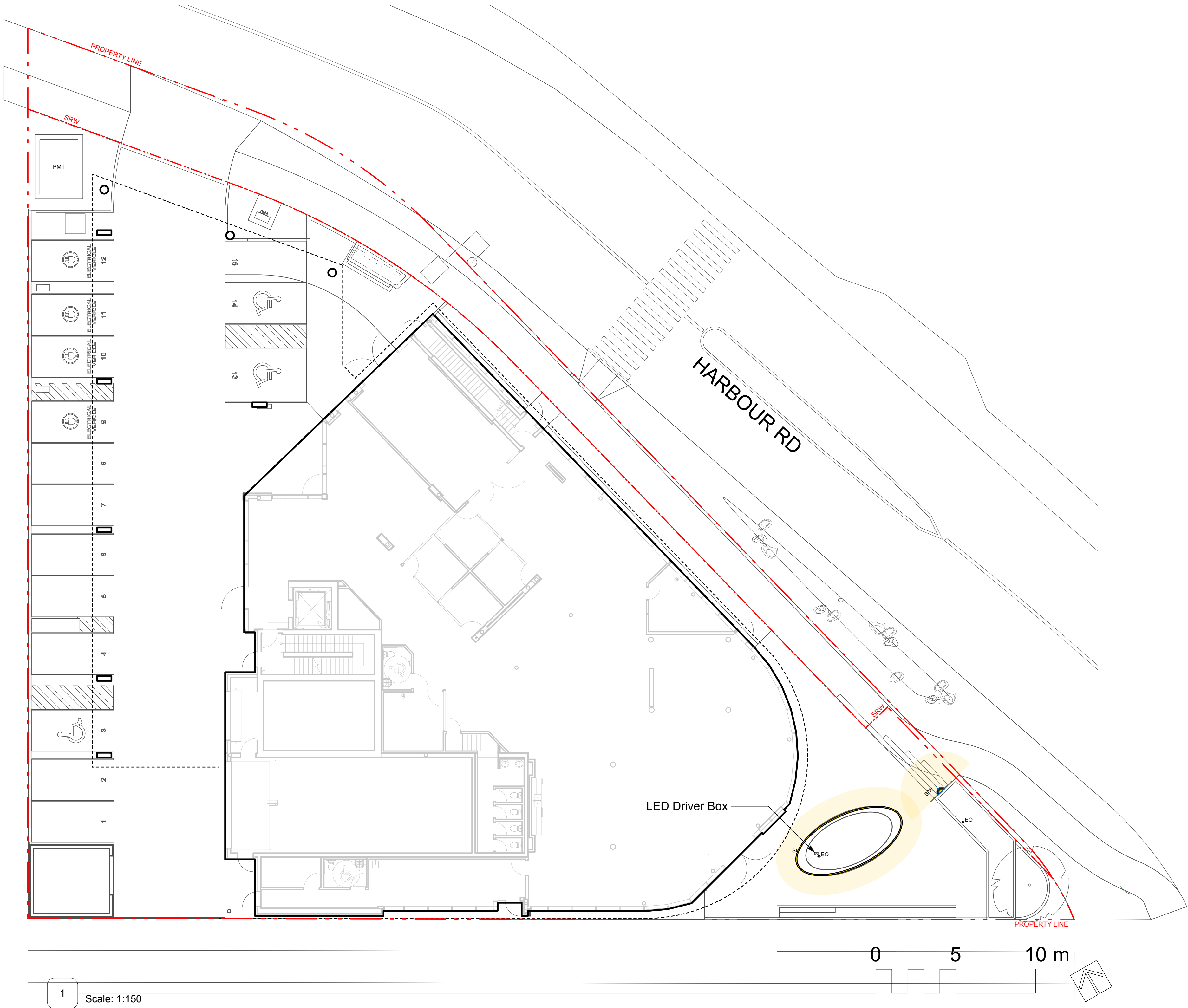



<b>Revision</b>		
<b>No.</b>	<b>Date</b>	<b>Revision Notes</b>

Issue No.	Date	Issue Notes
A	2025-06-11	Issued for DP Draft
B	2025-07-11	Issued for DP
C	2025-12-11	Reissued for DP

Professional Seal

**eta** landscape architecture

1690 West 2nd Avenue  
Vancouver, BC, Canada, V6J 1H4

t | 604.683.1456  
f | 604.683.1459  
w | [www.etal.ca](http://www.etal.ca)

**All Rights Reserved by eta landscape architecture inc.**  
Information contained on these documents is part of the Consultant's instruments of service, and the Consultant shall retain ownership thereof. Such information shall not be used for any purpose other than for the construction of the referenced project. Any other use, reuse or modification of the documents without the Consultant's prior written consent will be at the recipient's sole risk and without liability or legal exposure to the Consultant.

Project

## Victoria Porsche

202 Harbour Rd, Victoria, BC, V9A 3S2

Drawing Title

## Landscape Grading & Drainage Plan - Ground Level

Legal

Project Manager	Project ID
Project Manager	#####
Drawn By	Scale
Drawn By	As Noted
Reviewed By	Drawing No.
Reviewed By	<b>L5.0</b>
	10
	of
	30





Revision		
No.	Date	Revision Notes

Issue		
No.	Date	Issue Notes
A	2025-06-11	Issued for DP Draft
B	2025-07-11	Issued for DP
C	2025-12-11	Reissued for DP

Professional Seal

**eta** landscape architecture

1690 West 2nd Avenue  
Vancouver , BC , Canada , V6J 1H4

t | 604.683.1456  
f | 604.683.1459  
w | www.etalala.ca

All Rights Reserved by eta landscape architecture inc.  
Information contained on these documents is part of the Consultant's instruments of service, and the Consultant shall retain ownership thereof. Such information shall not be used for any purpose other than for the construction of the referenced project. Any other use, reuse or modification of the documents without the Consultant's prior written consent will be at the recipient's sole risk and without liability or legal exposure to the Consultant.

Project

**Victoria Porsche**

202 Harbour Rd, Victoria, BC, V9A 3S2

Drawing Title

**Tree Plan - Ground  
Level**

Legal

Project Manager	Project ID
Project Manager	#####
Drawn By	Scale
Drawn By	As Noted
Reviewed By	Drawing No.
Reviewed By	<b>L6.0</b>
	11 of 30





2 Scale: 1:150

Revision		
No.	Date	Revision Notes

Issue		
No.	Date	Issue Notes
A	2025-06-11	Issued for DP Draft
B	2025-07-11	Issued for DP
C	2025-12-11	Reissued for DP

Professional Seal

**eta** landscape architecture

1690 West 2nd Avenue  
Vancouver , BC , Canada , V6J 1H4

t | 604.683.1456  
f | 604.683.1459  
w | www.etalala.ca

All Rights Reserved by eta landscape architecture inc.  
Information contained on these documents is part of the Consultant's instruments of service, and the Consultant shall retain ownership thereof. Such information shall not be used for any purpose other than for the construction of the referenced project. Any other use, reuse or modification of the documents without the Consultant's prior written consent will be at the recipient's sole risk and without liability or legal exposure to the Consultant.

Project  
**Victoria Porsche**

202 Harbour Rd, Victoria, BC, V9A 3S2

Drawing Title  
**Offsite Planting Plan**

Legal

Project Manager	Project ID
Project Manager	####
Drawn By	Scale
Drawn By	As Noted
Reviewed By	Drawing No.
Reviewed By	<b>L6.1</b>
	12 of 30





Revision		
No.	Date	Revision Notes

Issue		
No.	Date	Issue Notes
A	2025-06-11	Issued for DP Draft
B	2025-07-11	Issued for DP
C	2025-12-11	Reissued for DP

Professional Seal

**eta** landscape architecture

1690 West 2nd Avenue  
Vancouver , BC , Canada , V6J 1H4

**t** | 604.683.1456  
**f** | 604.683.1459  
**w** | www.etalala.ca

All Rights Reserved by eta landscape architecture inc.  
Information contained on these documents is part of the Consultant's instruments of service, and the Consultant shall retain ownership thereof. Such information shall not be used for any purpose other than for the construction of the referenced project. Any other use, reuse or modification of the documents without the Consultant's prior written consent will be at the recipient's sole risk and without liability or legal exposure to the Consultant.

Project

**Victoria Porsche**

202 Harbour Rd, Victoria, BC, V9A 3S2

Drawing Title

**Planting Plan -  
Ground Level**

Legal

Project Manager	Project ID
Project Manager	####
Drawn By	Scale
Drawn By	As Noted
Reviewed By	Drawing No.
Reviewed By	<b>L6.2</b>
	13 of 30



Revision		
No.	Date	Revision Notes

Issue		
No.	Date	Issue Notes
A	2025-06-11	Issued for DP Draft
B	2025-07-11	Issued for DP
C	2025-12-11	Reissued for DP

Professional Seal

**eta** landscape architecture

1690 West 2nd Avenue  
Vancouver , BC , Canada , V6J 1H4

t | 604.683.1456  
f | 604.683.1459  
w | www.etalala.ca

All Rights Reserved by eta landscape architecture inc.  
Information contained on these documents is part of the Consultant's instruments of service, and the Consultant shall retain ownership thereof. Such information shall not be used for any purpose other than for the construction of the referenced project. Any other use, reuse or modification of the documents without the Consultant's prior written consent will be at the recipient's sole risk and without liability or legal exposure to the Consultant.

Project

**Victoria Porsche**

202 Harbour Rd, Victoria, BC, V9A 3S2

Drawing Title

**Soil Depth &  
Servicing Plan -  
Ground Level**

Legal

Project Manager	Project ID
Project Manager	#####
Drawn By	Scale
Drawn By	As Noted
Reviewed By	Drawing No.
Reviewed By	<b>L7.0</b>
	14 of 30

PLANTING SOIL DEPTH LEGEND

150 mm (6") Soil Depth

300 mm (12") Soil Depth

610 mm (24") Soil Depth

915 mm (36") Soil Depth

Note:

All softscape areas to include min. 75mm gravel drainage layers in addition to indicated soil depth for on slab conditions.

IRRIGATED AREAS & SERVICING LEGEND

Irrigation Stub-out

Hosebib

Gas Connection

\*All onsite planted areas to be irrigated with high efficiency irrigation system.\*

Note:

1. Refer to canadian landscape standard, typ.  
2. This sheet is for reference only, Contractor to refer to Irrigation drawings for the Irrigation design.  
3. Final locations per Mechanical.  
4. Shop drawings to be provided prior to installation for Landscape review.  
5. Electrical outlets to be provided for each BBQ, Trellis, and Fire Table, if applicable. Refer to Electrical.





Revision		
No.	Date	Revision Notes

Issue		
No.	Date	Issue Notes
A	2025-06-11	Issued for DP Draft
B	2025-07-11	Issued for DP
C	2025-12-11	Reissued for DP

Professional Seal

**eta** landscape architecture

1690 West 2nd Avenue  
Vancouver , BC , Canada , V6J 1H4

t | 604.883.1456  
f | 604.883.1459  
w | www.etalala.ca

All Rights Reserved by eta landscape architecture inc.  
Information contained on these documents is part of the Consultant's instruments of service, and the Consultant shall retain ownership thereof. Such information shall not be used for any purpose other than the construction of the referenced project. Any other use, reuse or modification of the documents without the Consultant's prior written consent will be at the recipient's sole risk and without liability or legal exposure to the Consultant.

Project

**Victoria Porsche**

202 Harbour Rd, Victoria, BC, V9A 3S2

Drawing Title

**Soil Depth &  
Servicing Plan  
-Upper Levels**

Legal

Project Manager	Project ID
Project Manager	#####
Drawn By	Scale
Drawn By	As Noted
Reviewed By	Drawing No.
Reviewed By	<b>L7.1</b>
	15 of 30

PLANTING SOIL DEPTH LEGEND

150 mm (6") Soil Depth

300 mm (12") Soil Depth

610 mm (24") Soil Depth

915 mm (36") Soil Depth

Note:

All softscape areas to include min. 75mm gravel drainage layers in addition to indicated soil depth for on slab conditions.

IRRIGATED AREAS & SERVICING LEGEND

IS

→

Irrigation Stub-out

HB

→

Hosebib

GB

→

Gas Connection

\*All onsite planted areas to be irrigated with high efficiency irrigation system.\*

Note:

1. Refer to canadian landscape standard, typ.  
2. This sheet is for reference only, Contractor to refer to Irrigation drawings for the Irrigation design.  
3. Final locations per Mechanical.  
4. Shop drawings to be provided prior to installation for Landscape review.  
5. Electrical outlets to be provided for each BBQ, Trellis, and Fire Table, if applicable. Refer to Electrical.

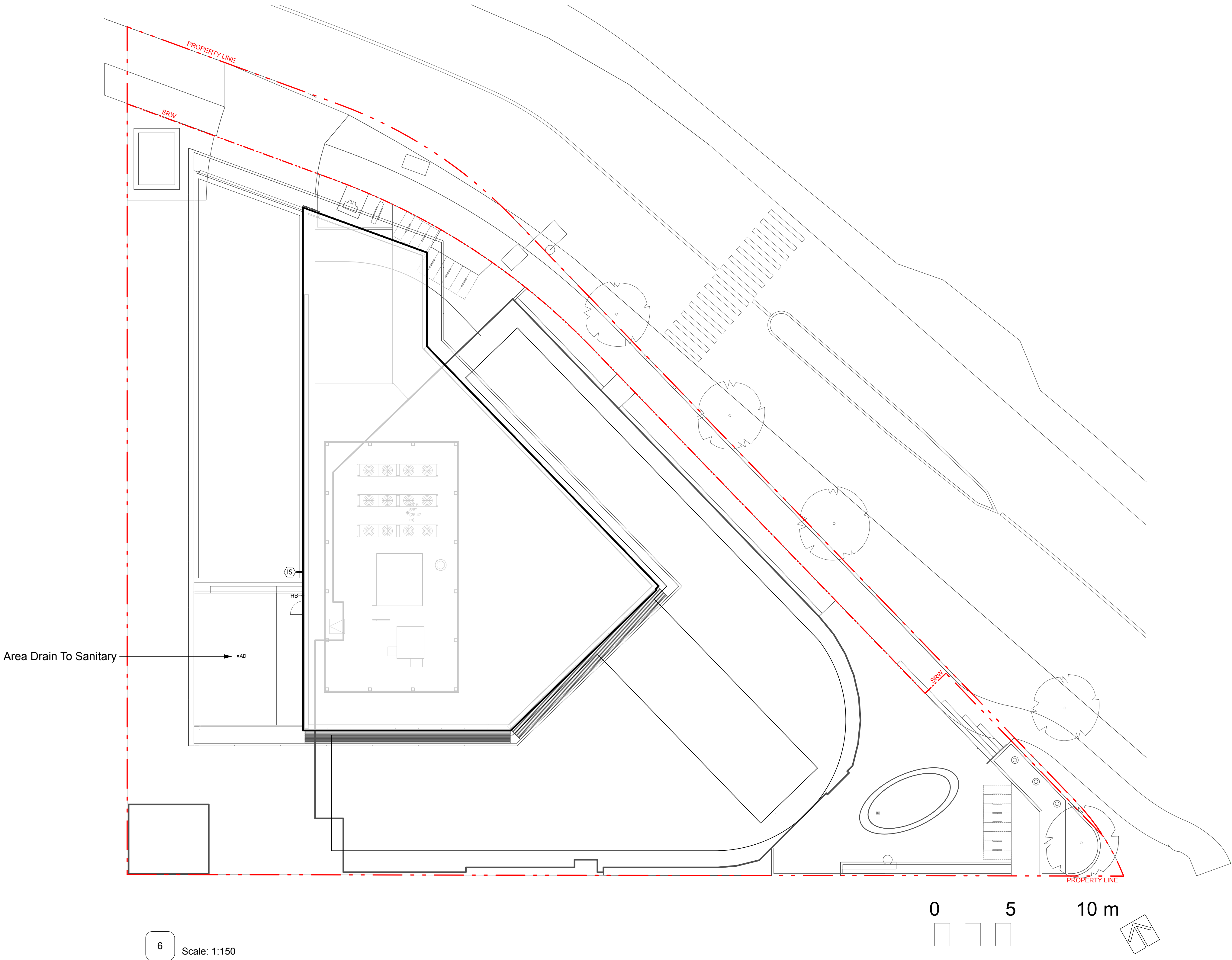



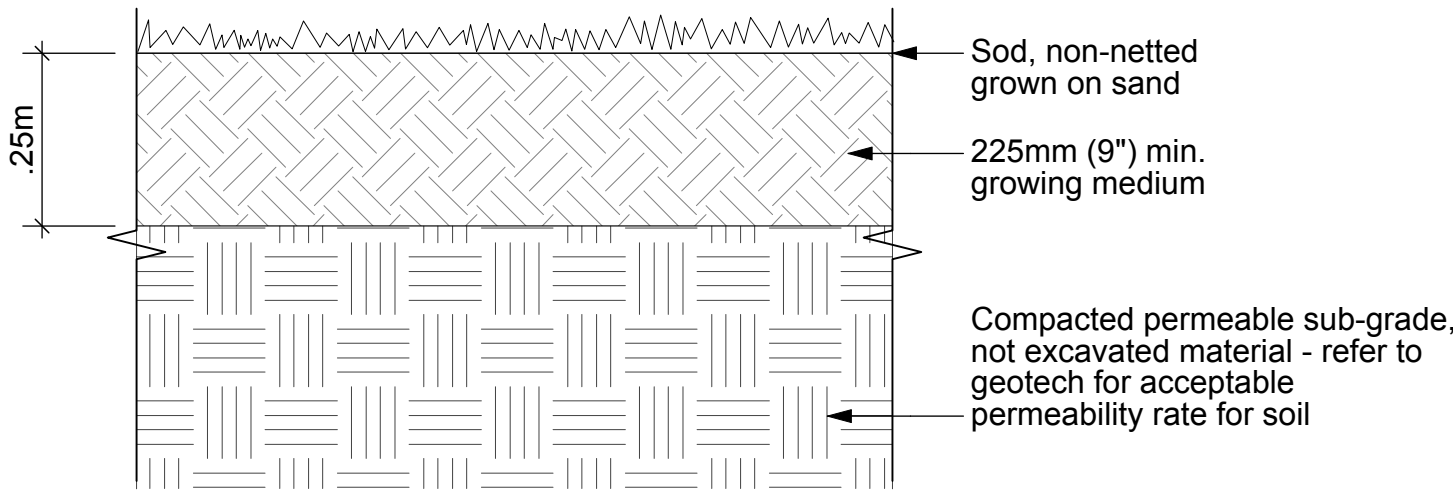

1 DETAIL: Sod at Grade  
Scale: 1:10

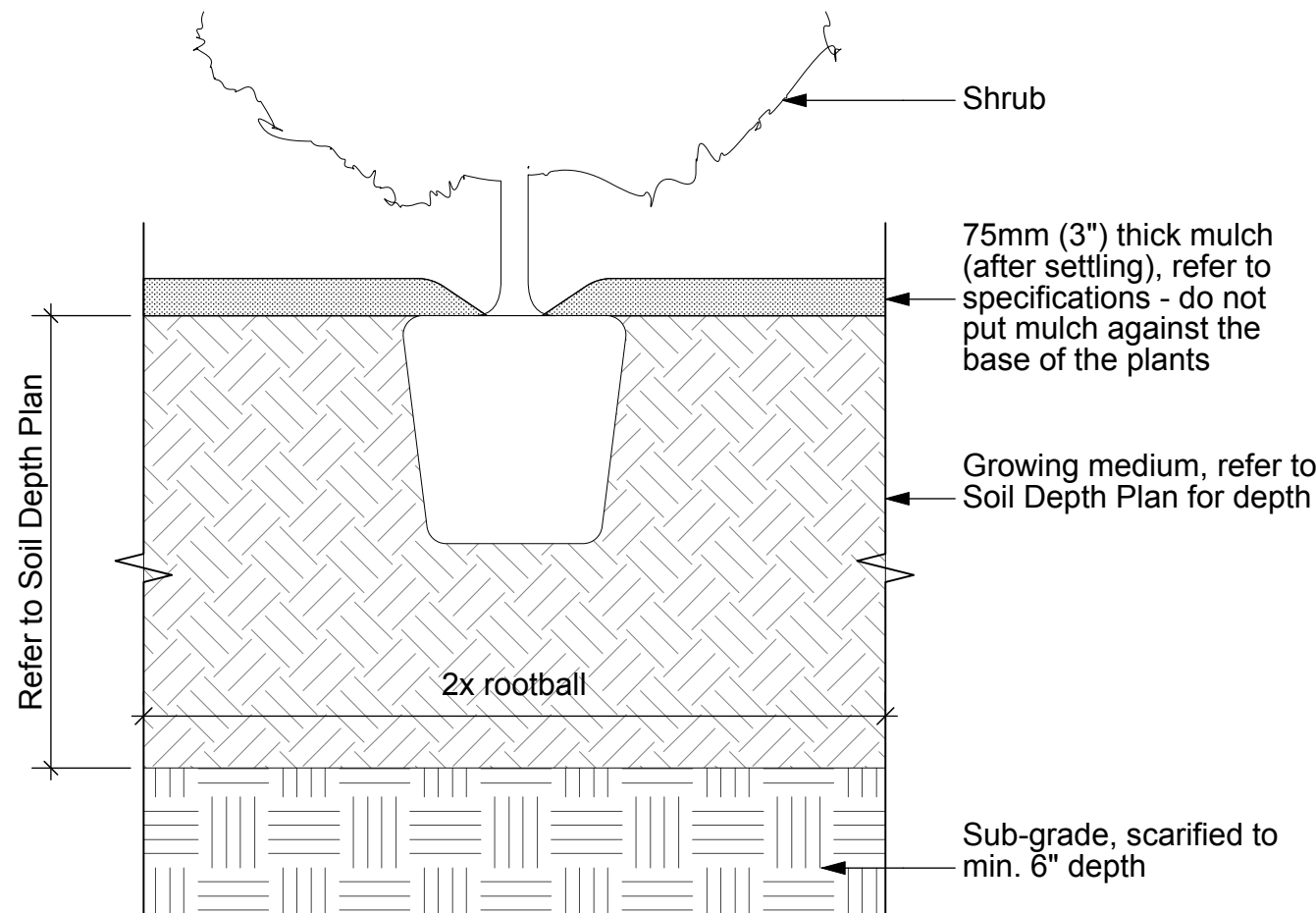

2 DETAIL: Planting at Grade  
Scale: 1:10

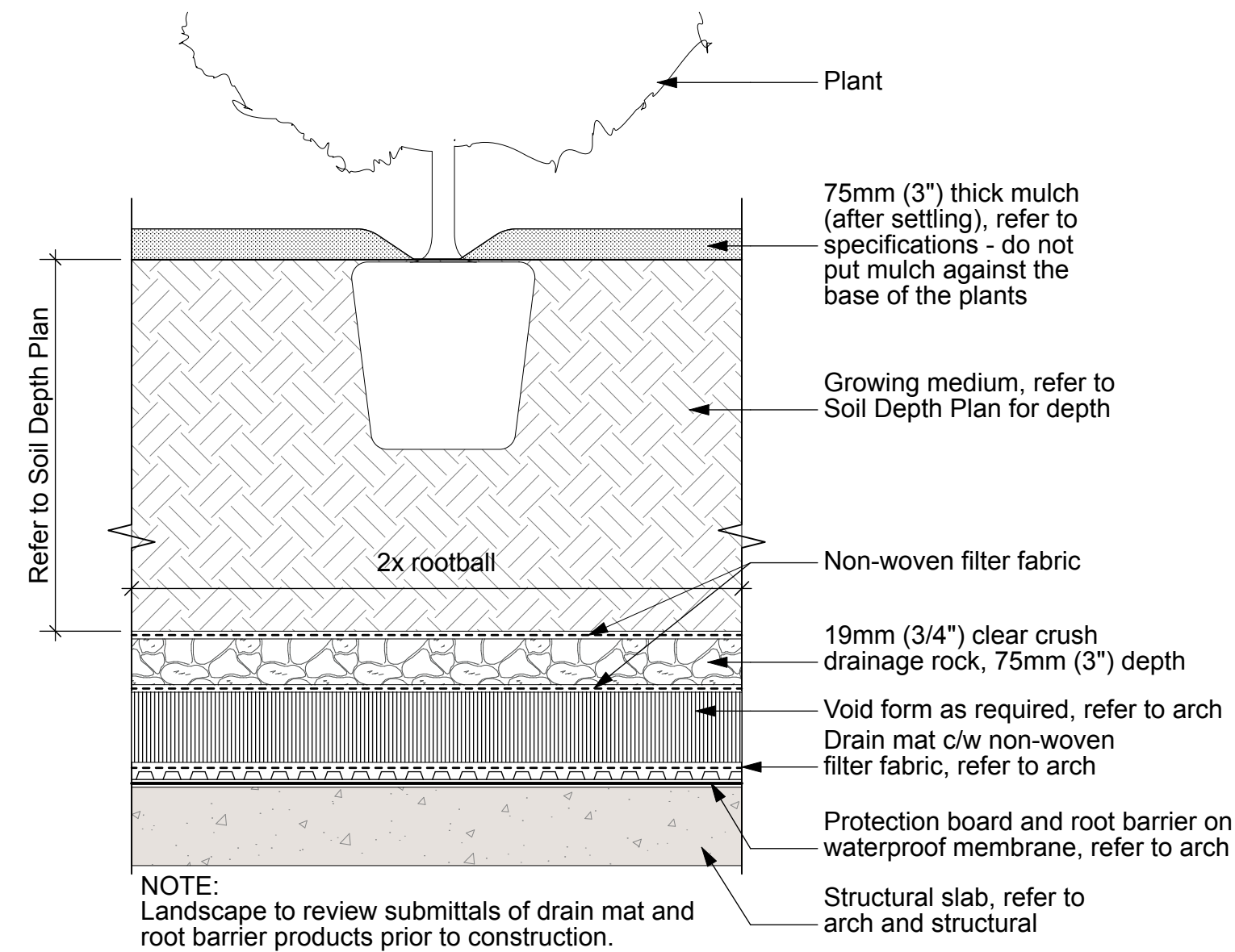

3 DETAIL: Planting on Slab  
Scale: 1:10

Revision		
No.	Date	Revision Notes

Issue		
No.	Date	Issue Notes
A	2025-06-11	Issued for DP Draft
B	2025-07-11	Issued for DP
C	2025-12-11	Reissued for DP

Professional Seal

**eta** landscape architecture

1690 West 2nd Avenue  
Vancouver , BC , Canada , V6J 1H4

t | 604.683.1456  
f | 604.683.1459  
w | www.etalala.ca

All Rights Reserved by eta landscape architecture inc.  
Information contained on these documents is part of the Consultant's instruments of service, and the Consultant shall retain ownership thereof. Such information shall not be used for any purpose other than for the construction of the referenced project. Any other use, reuse or modification of the documents without the Consultant's prior written consent will be at the recipient's sole risk and without liability or legal exposure to the Consultant.

Project

**Victoria Porsche**

202 Harbour Rd, Victoria, BC, V9A 3S2

Drawing Title

**Softscape Details**

Legal

Project Manager	Project ID
Project Manager	#####
Drawn By	Scale
Drawn By	As Noted
Reviewed By	Drawing No.
Reviewed By	<b>L9.1</b>
	19 of 30

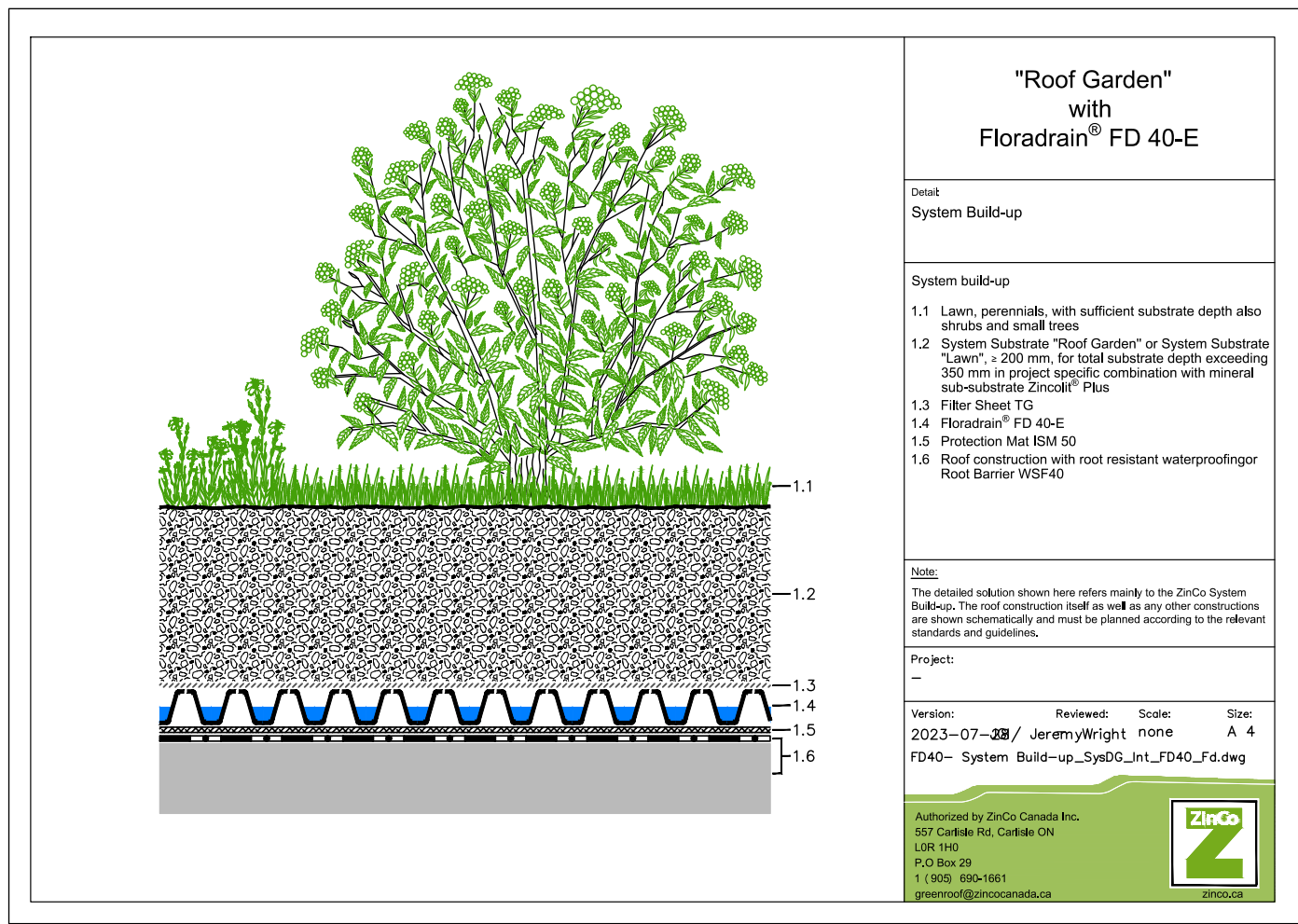

4 CUTSHEET: Intensive Green roof

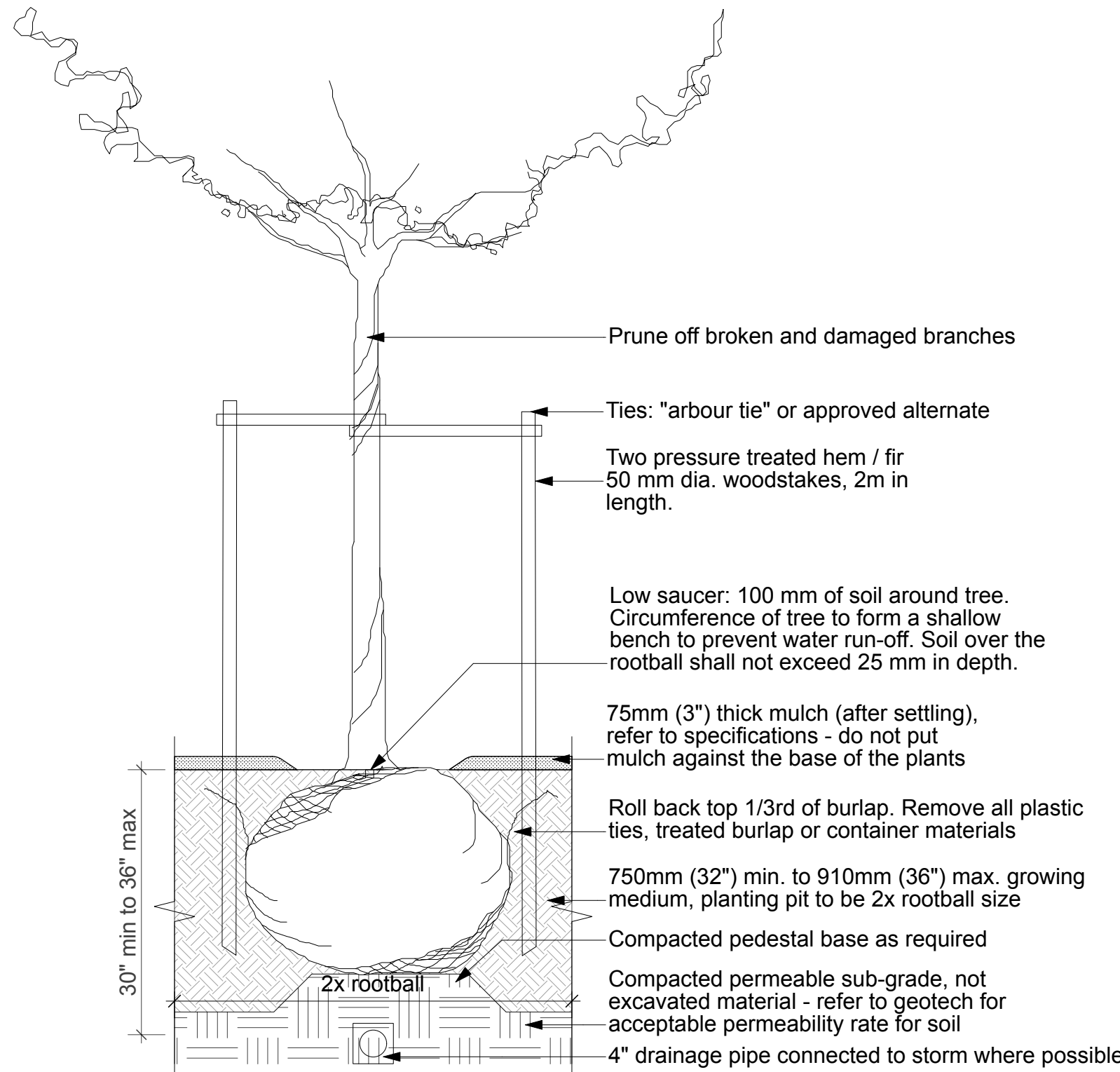

Notes:  
-Minimum Width Of Tree Pit Shall Be The Rootball Diameter Plus 24"  
-Tree Wells Shall Be 36 inch Depth  
-Tree Wells In Boulevards Shall Be Connected By A Continuous Soil Trench Of At Least 910mm (36 inch) Depth

6 DETAIL: TREE AT GRADE  
SCALE: 1:20

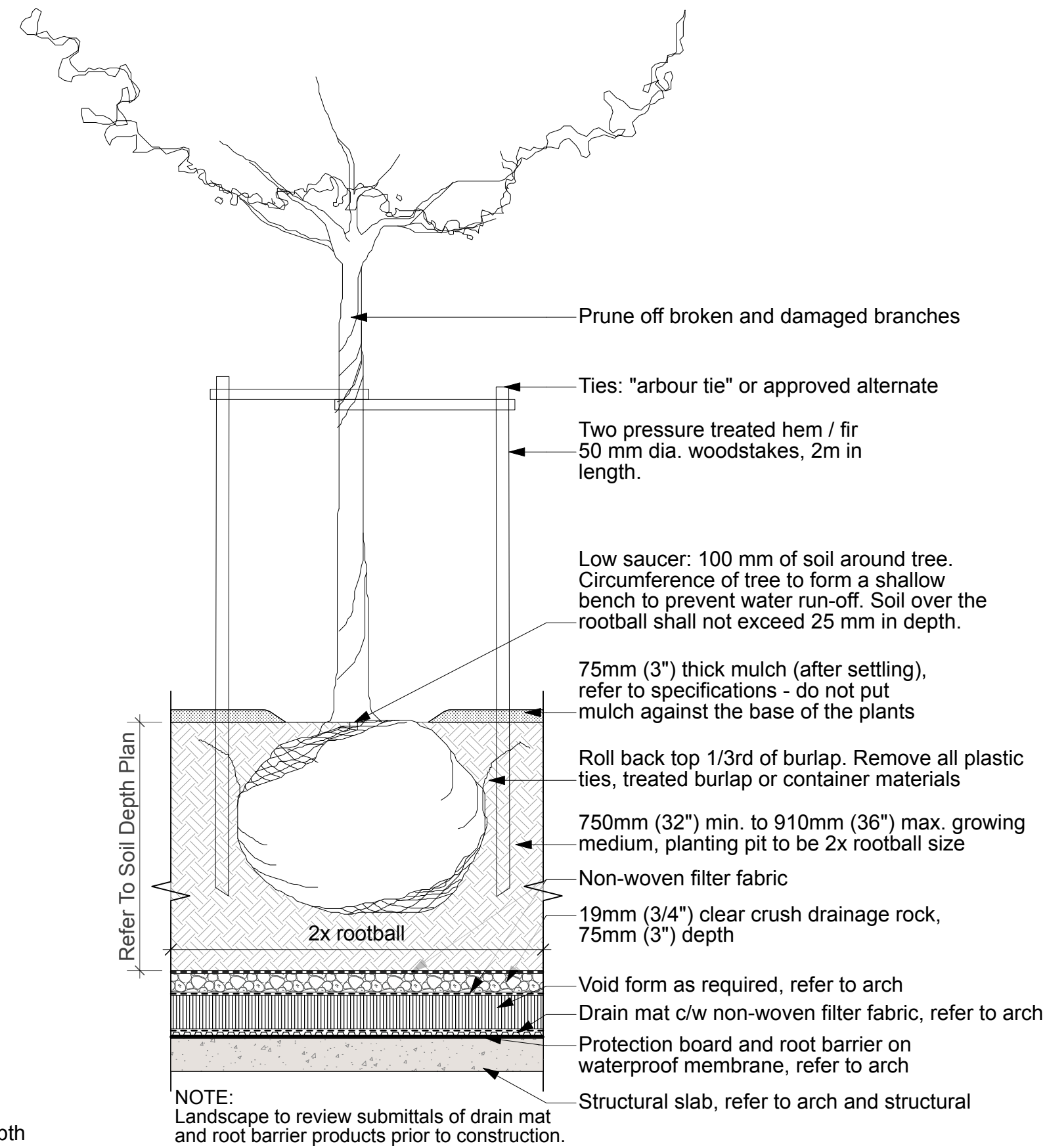

7 DETAIL: TREE ON SLAB  
SCALE: 1:20



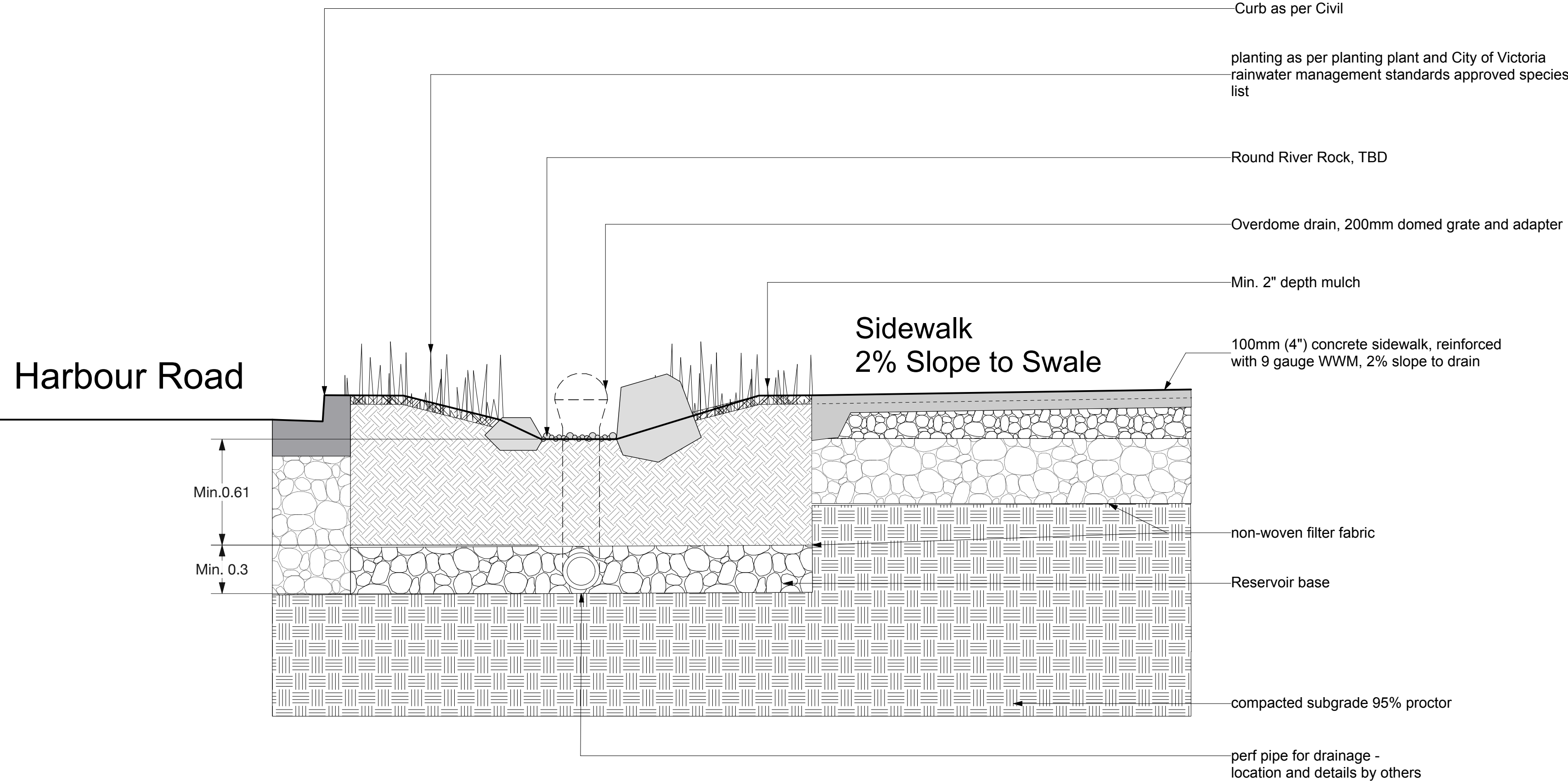

- PLANTING NOTES:**
- 1. All trees shall meet or exceed City of Victoria tree specifications.
  - 2. Coordination with City of Victoria Engineering and Public Works may be required.
  - 3. Trees require inspection prior to planting. Call urban forestry services to schedule an inspection, min. 48 hours notice.
  - 4. Tree preparation:
    - A. Container grown - Remove completely from container.
    - B. Burlap and rope - Remove top 1/3 covering.
    - C. Wire and burlap - Remove top 1/3 of covering without damaging root ball.

5 Detail: Rain Garden

Revision		
No.	Date	Revision Notes

Issue		
No.	Date	Issue Notes
A	2025-06-11	Issued for DP Draft
B	2025-07-11	Issued for DP
C	2025-12-11	Reissued for DP

Professional Seal

**eta** landscape architecture

1690 West 2nd Avenue  
Vancouver , BC , Canada , V6J 1H4

t | 604.683.1456  
f | 604.683.1459  
w | www.etalala.ca

All Rights Reserved by eta landscape architecture inc.  
Information contained on these documents is part of the Consultant's instruments of service, and the Consultant shall retain ownership thereof. Such information shall not be used for any purpose other than for the construction of the referenced project. Any other use, reuse or modification of the documents without the Consultant's prior written consent will be at the recipient's sole risk and without liability or legal exposure to the Consultant.

Project

**Victoria Porsche**

202 Harbour Rd, Victoria, BC, V9A 3S2

Drawing Title

**Softscape Details**

Legal

Project Manager	Project ID
Project Manager	#####
Drawn By	Scale
Drawn By	As Noted
Reviewed By	Drawing No.
Reviewed By	<b>L9.2</b>
	20
	of
	30



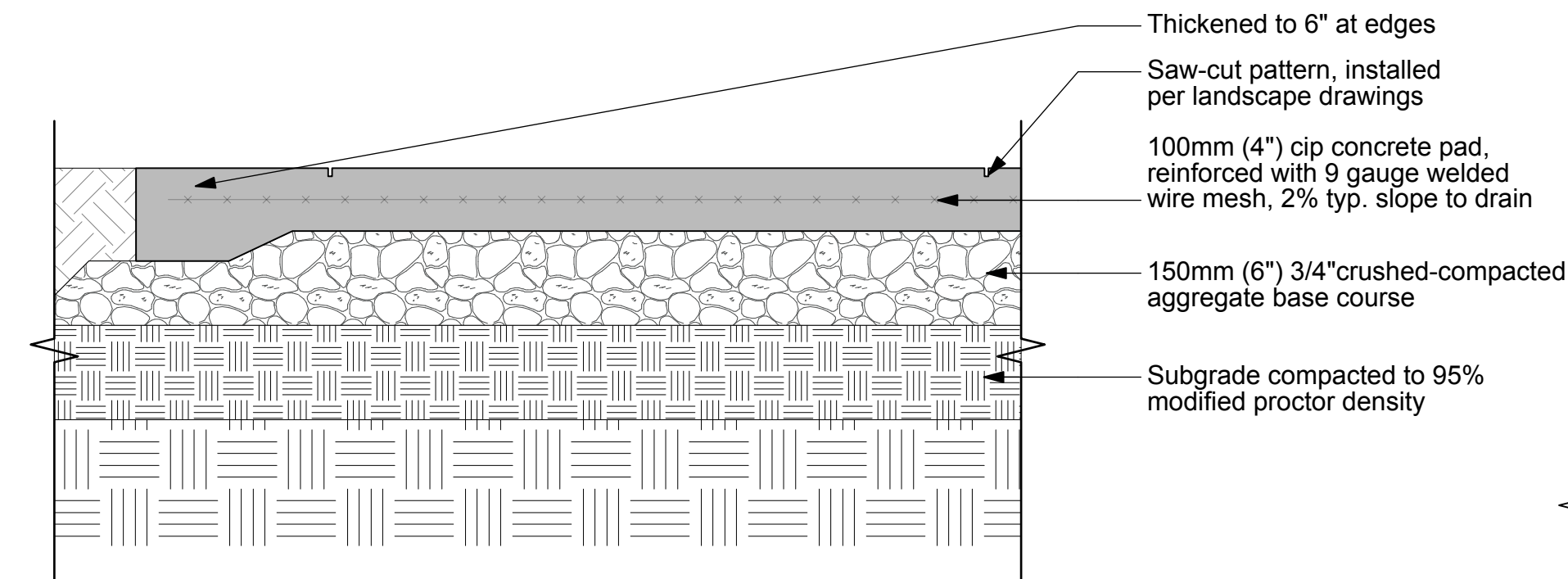

NOTE:  
-Saw-cuts to be installed per layout plan, completed within 24hrs of pouring the slab  
-Control joints to be 1/4 slab depth  
-Control joints max 3m OC, as per MMCD  
-Expansion joints to be max 9m OC as per MMCD  
-Concrete to be broom-finished unless otherwise noted

1 DETAIL: CIP Pedestrian Concrete at Grade  
Scale: 1:10

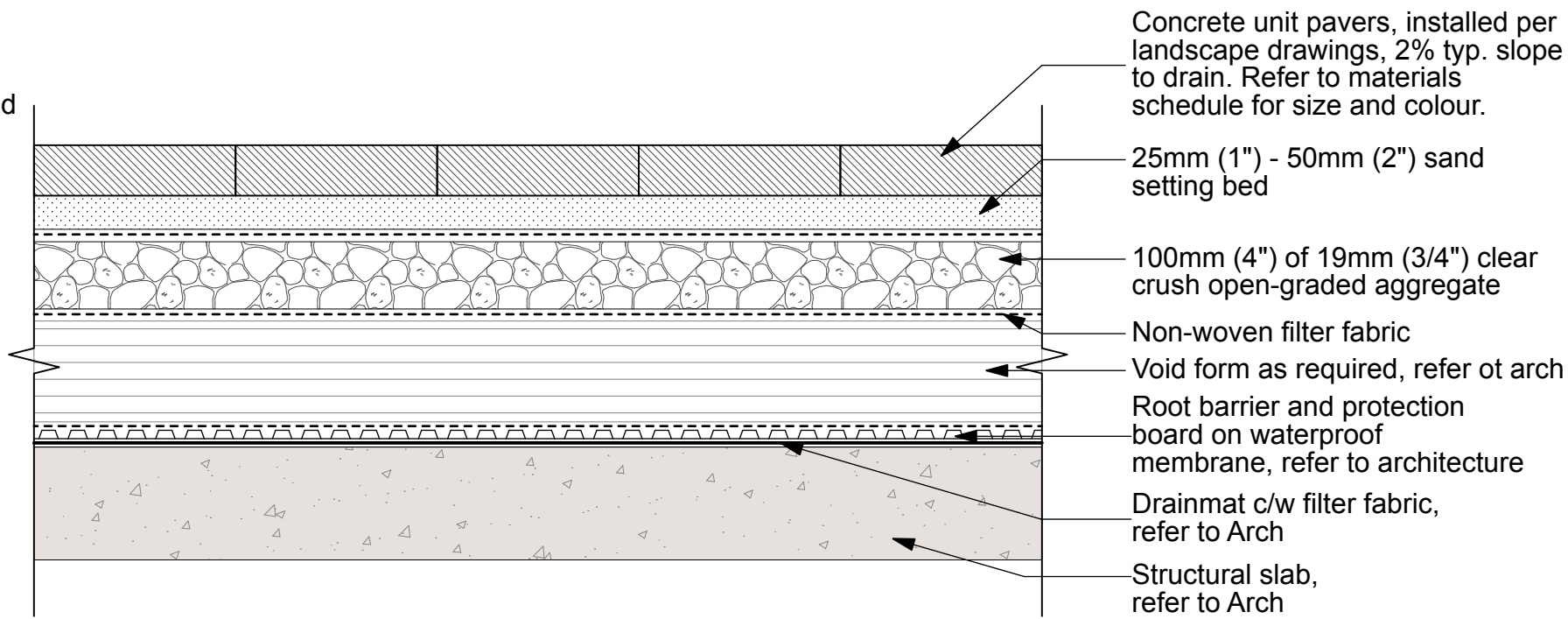

Note: Only adjustable height plastic risers to be used.  
Neoprene/rubber substitutes will not be accepted.

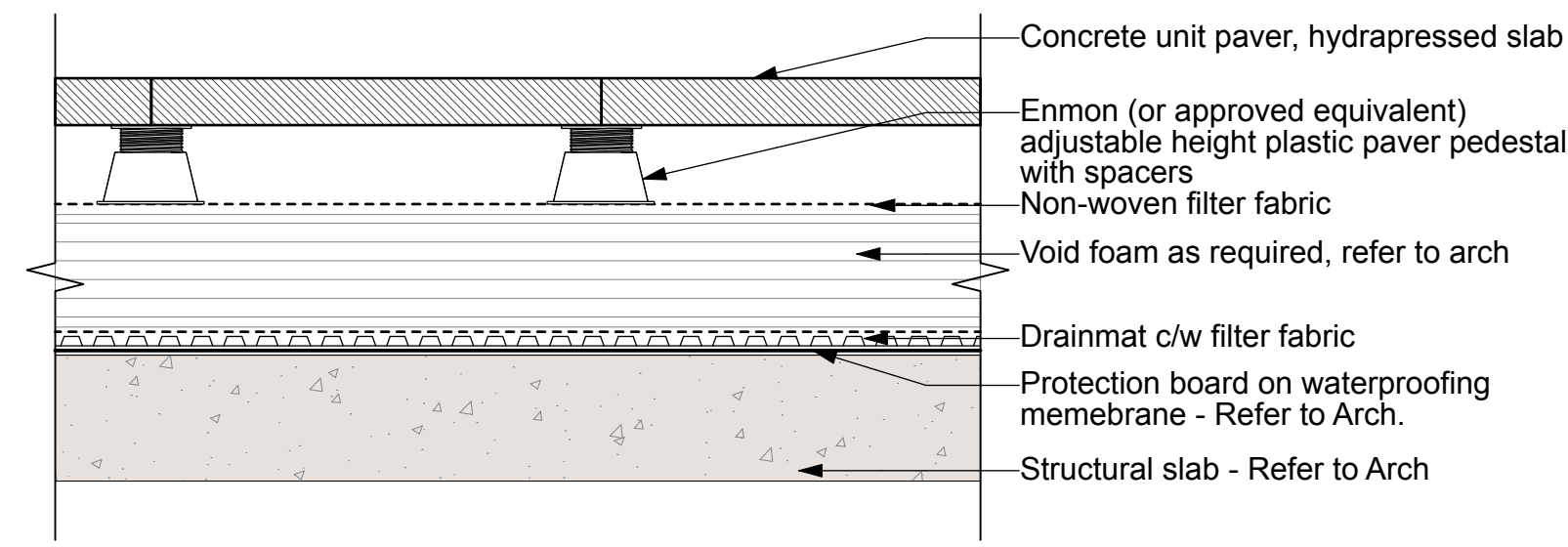

3 DETAIL: Paving Type 2  
Scale: 1:10

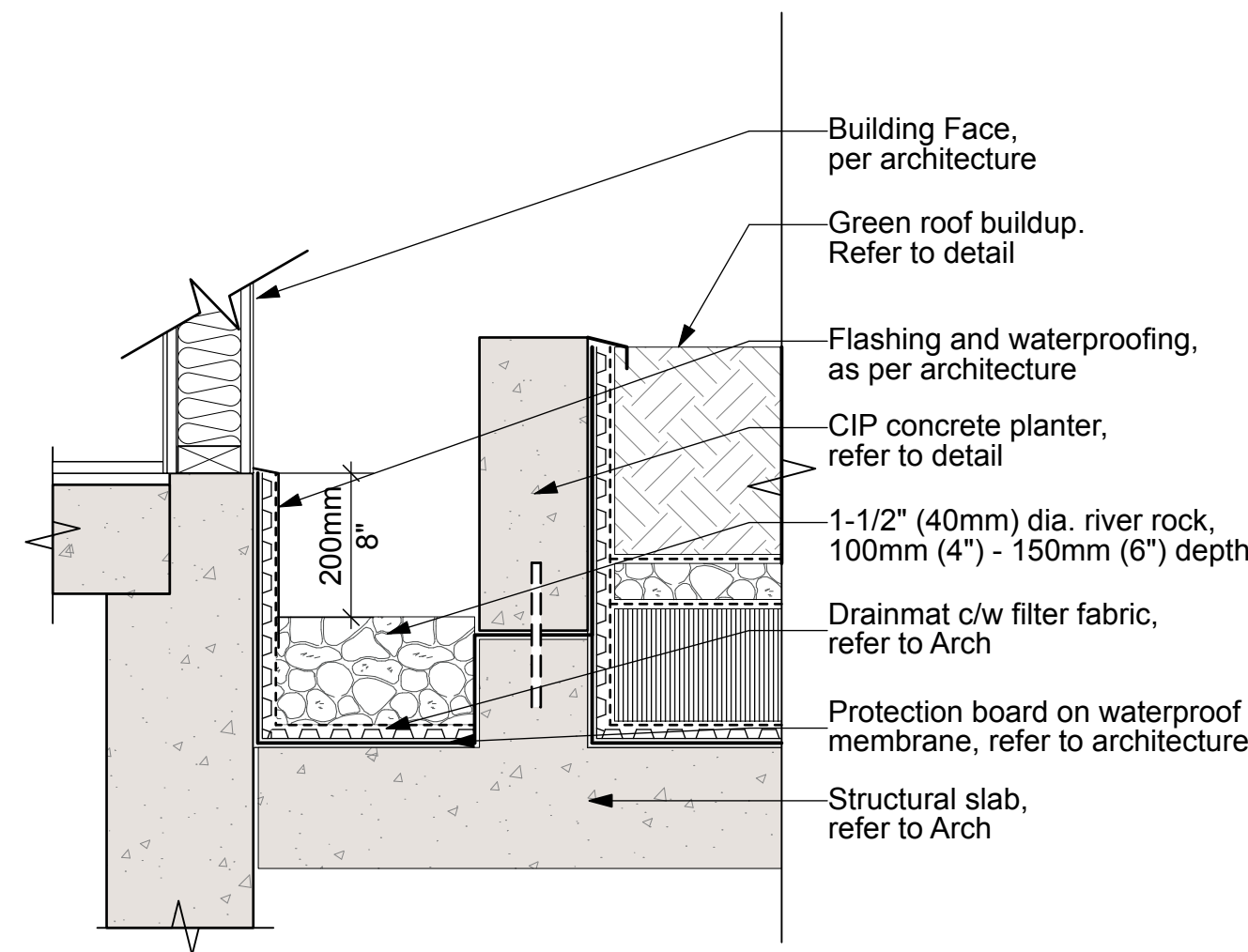

4 DETAIL: Drip Strip on Slab  
Scale: 1:10

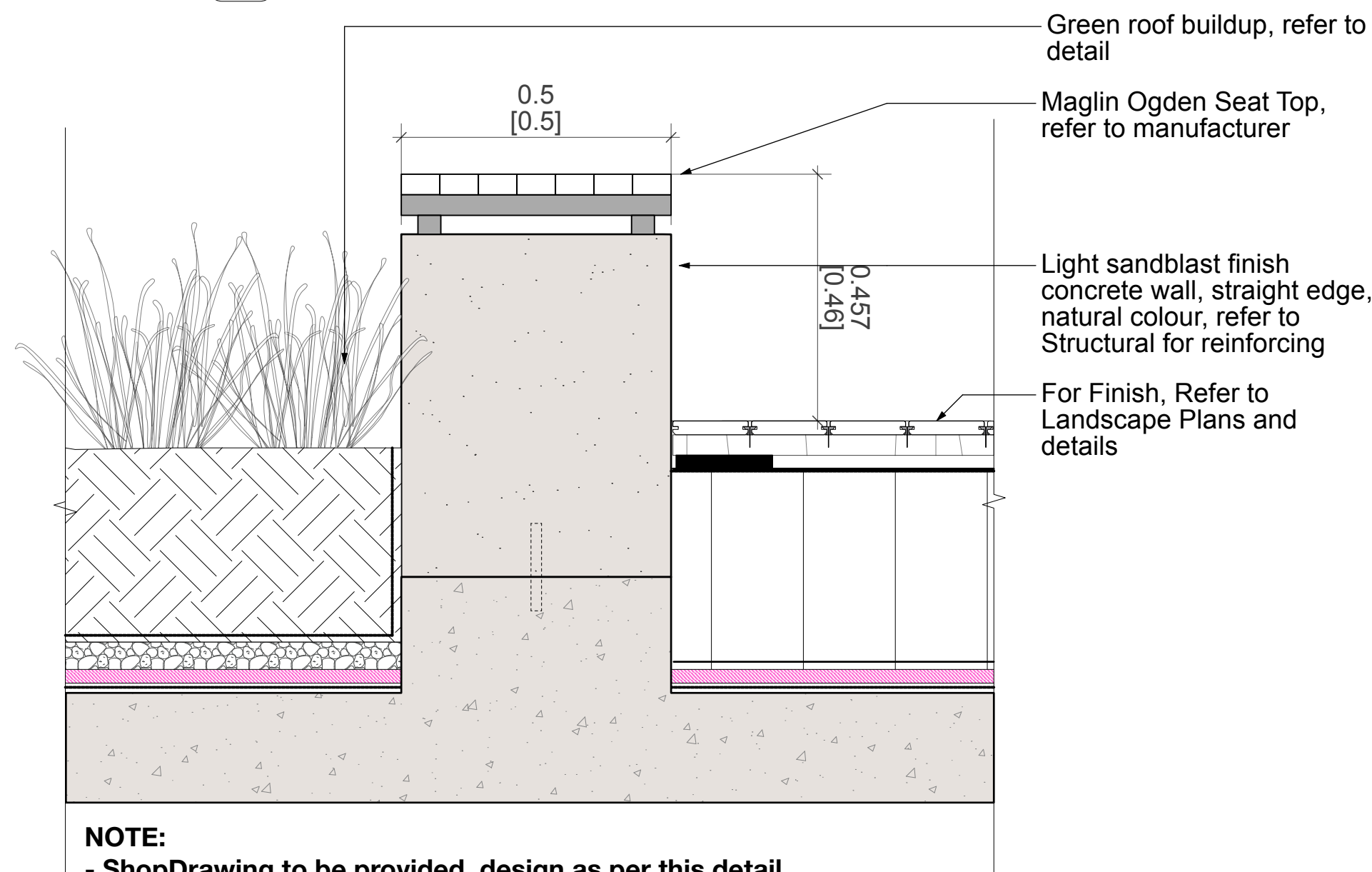

NOTE:  
- ShopDrawing to be provided, design as per this detail  
- To be coordinated with structure engineer

5 DETAIL: Timber Top Seating  
Scale: 1:10

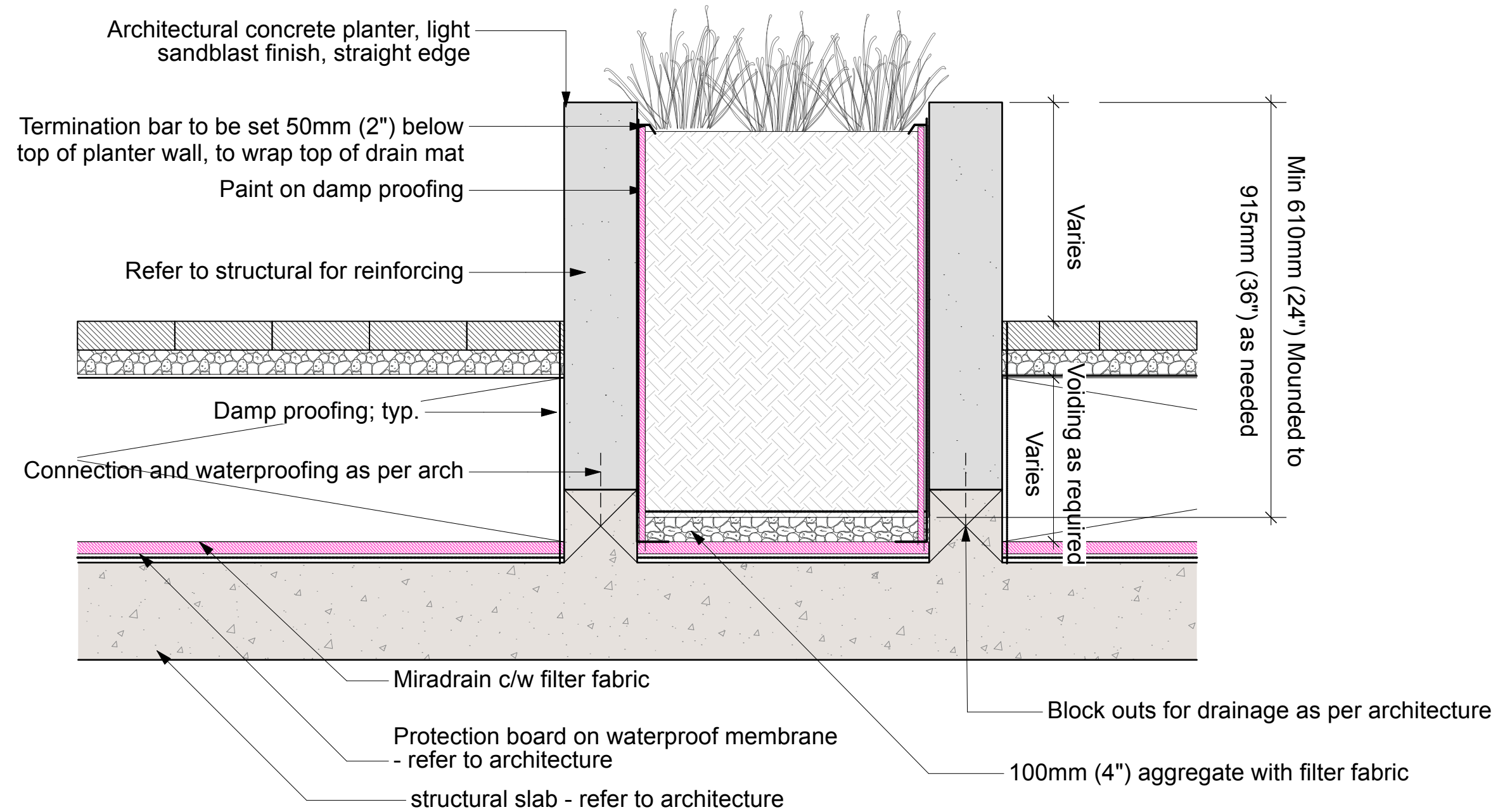

6 DETAIL: CIP Concrete Planter

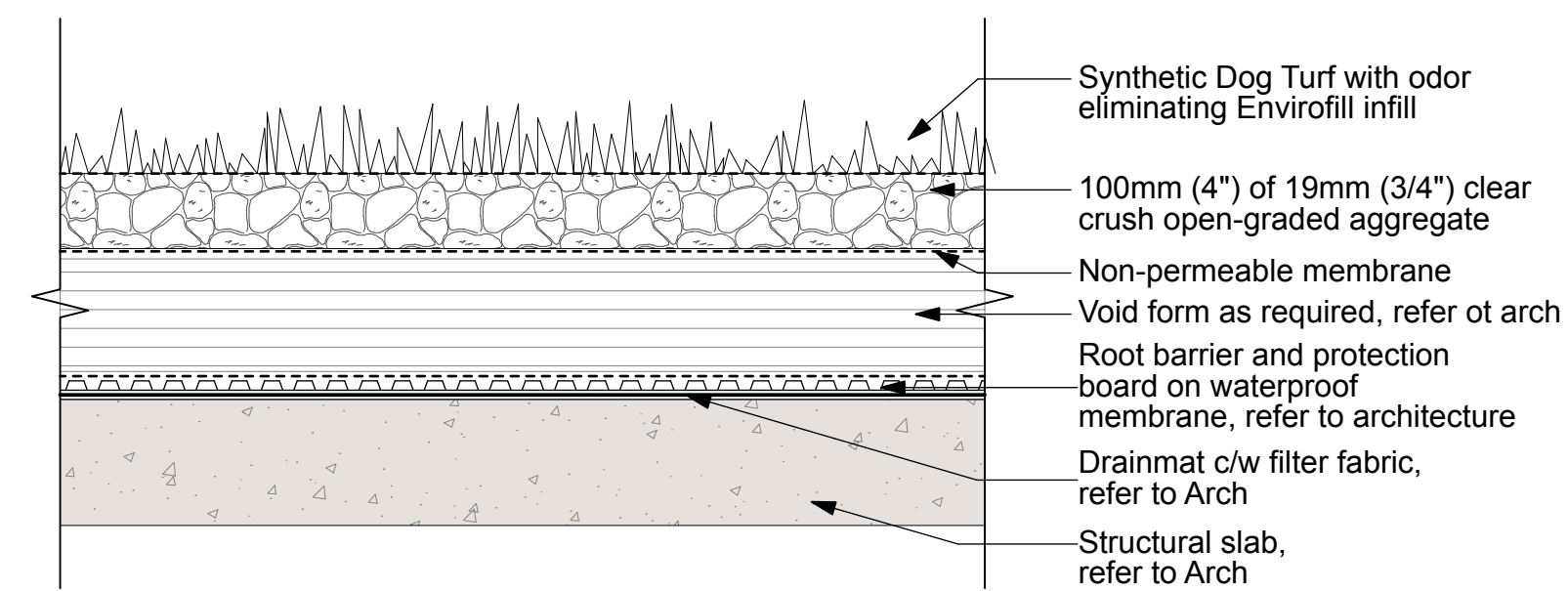

7 DETAIL: Artificial Turf  
Scale: 1:10

Revision		
No.	Date	Revision Notes

Issue		
No.	Date	Issue Notes
A	2025-06-11	Issued for DP Draft
B	2025-07-11	Issued for DP
C	2025-12-11	Reissued for DP

Professional Seal

**eta** landscape architecture

1690 West 2nd Avenue  
Vancouver , BC , Canada , V6J 1H4

t | 604.683.1456  
f | 604.683.1459  
w | www.etalala.ca

All Rights Reserved by eta landscape architecture inc.  
Information contained on these documents is part of the Consultant's instruments of service, and the Consultant shall retain ownership thereof. Such information shall not be used for any purpose other than for the construction of the referenced project. Any other use, reuse or modification of the documents without the Consultant's prior written consent will be at the recipient's sole risk and without liability or legal exposure to the Consultant.

Project

**Victoria Porsche**

202 Harbour Rd, Victoria, BC, V9A 3S2

Drawing Title

**Hardscape Details**

Legal

Project Manager	Project ID
Drawn By	Scale
Reviewed By	Drawing No.
L9.3	
21	
of	
30	



MBR-1600-00007

Legacy # SCBR1600-DG



Sustainability Facts

Last Mile One (1) MBR-1600-00001 Bike Rack

Carbon footprint (GWP) 64 kg CO2-Eq

Renewable (Percentage of carbon derived from renewable) 0%

Total energy use (EUI) 2723 MJ-Eq

Renewable (Percentage of energy generated) 0%

Water use (WUPT) 3.58 m3 water

Renewable (Percentage of water generated from renewable) 0%

Material recyclability 100%

LEED v4 Credits

Type II Environmental Product Declaration

Material Inventory

Low VOC Finishes

Recycled Content Declaration

Recycled Content Declaration

DESCRIPTION: 1600 Series - SC Bike Rack, Cast Aluminum, Direct Burial, 2 Bike Configuration

FINISH: The Maglin Powdercoat System provides a durable finish on all metal surfaces. Wood slats are treated with penetrating sealers.

INSTALLATION: The bike rack is delivered pre-assembled. It is available with either a surface mount or direct burial installation option.

TO SPECIFY: Select MBR-1600-00007  
Choose  
→ Powdercoat Color

HEIGHT: 36.35" (92.3cm)LENGTH: 27.5" (69.8cm)WIDTH: 3.35" (8.5cm)WEIGHT: 22 lbs (10kg)

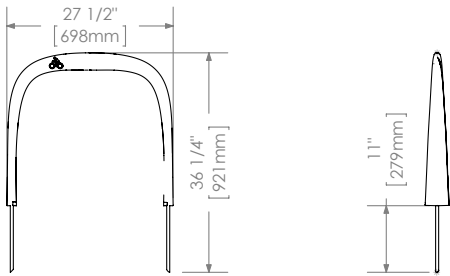



1600 Series  
P.O. Box 1600  
4001 2nd Ave  
Vancouver, BC  
V6J 1H4  
Canada  
www.maglin.com  
info@maglin.com

At all times, specifications, design and details on this page remain the property of Maglin Site Furniture Inc. and may not be used without Maglin Site Furniture Inc. permission.  
Details and specifications may vary due to manufacturing imperfections or our products.

MTB-1800-00001



BATTERY

MATERIALS: The table top surface is steel with a pattern of holes. The post and frame are steel. The base is covered with a stainless steel cap.

FINISH: All steel components are protected with E-Coat rust proofing. The Maglin Powdercoat System provides a durable finish on all metal surfaces.

INSTALLATION: The table comes pre-assembled. 4 leveling feet are provided.

TO SPECIFY: Select MTB-1800-00001  
Choose  
→ Powdercoat Color

HEIGHT: 29.00" (73.7cm)DIAMETER: 36.00" (91.4cm)WEIGHT: 125lbs (57kg)

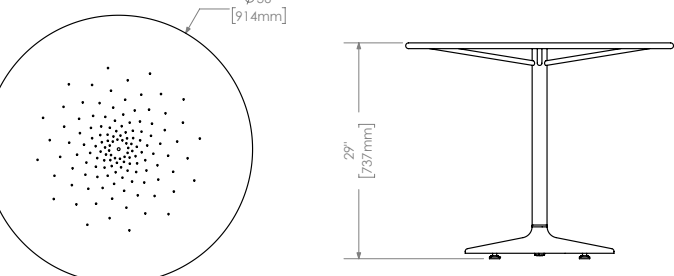



1800 Series  
P.O. Box 1800  
4001 2nd Ave  
Vancouver, BC  
V6J 1H4  
Canada  
www.maglin.com  
info@maglin.com

At all times, specifications, design and details on this page remain the property of Maglin Site Furniture Inc. and may not be used without Maglin Site Furniture Inc. permission.  
Details and specifications may vary due to manufacturing imperfections or our products.

RANGE 6 STRAIGHT

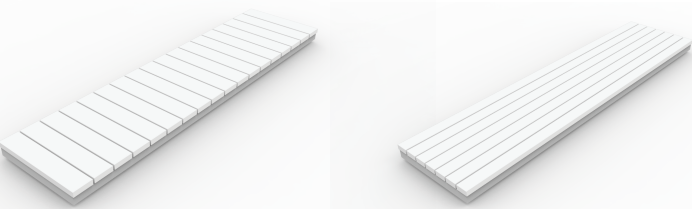

OGDEN

MATERIALS: The seat pan is constructed from steel. The seat employs LVL, HDPE (plastic), or HDPC (composite) slats. Postholes: 8" L x 10" D x 12" H (203 x 254 x 305 mm).

FINISH: All steel components are protected with E-Coat rust proofing. The Maglin Powdercoat System provides a durable finish on all metal surfaces.

INSTALLATION: The seats sections come pre-assembled with boards. Chosen mount option comes as a separate component. Reference: INSTALLATION-REI\_20042000 document for on-site assembly and installation.

TO SPECIFY: Please contact your Maglin Site Furniture Representative.

SQUARE LEG

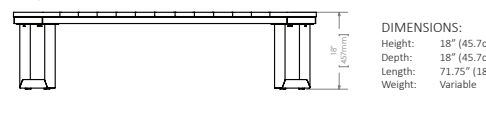

DIMENSIONS:

height 30" (762mm)

depth 30" (762mm)

length 13.5" (343mm)

weight 12.5 lbs (5.7kg)

PEDESTAL LEG

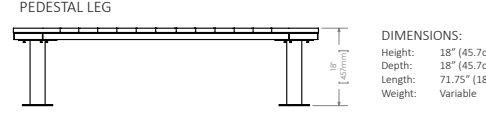

DIMENSIONS:

height 30" (762mm)

depth 30" (762mm)

length 13.5" (343mm)

weight 12.5 lbs (5.7kg)

WALL MOUNT

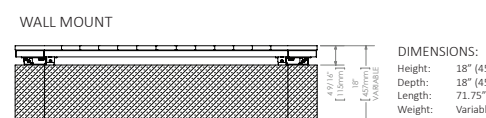

DIMENSIONS:

height 30" (762mm)

depth 30" (762mm)

length 13.5" (343mm)

weight 12.5 lbs (5.7kg)

CANTILEVER

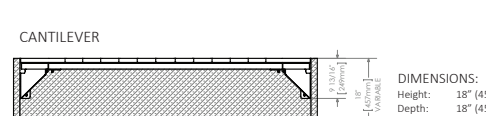

DIMENSIONS:

height 30" (762mm)

depth 30" (762mm)

length 13.5" (343mm)

weight 12.5 lbs (5.7kg)

At all times, specifications, design and details on this page remain the property of Maglin Site Furniture Inc. and may not be used without Maglin Site Furniture Inc. permission.  
Details and specifications may vary due to manufacturing imperfections or our products.

Revision		
No.	Date	Revision Notes

Issue		
No.	Date	Issue Notes
A	2025-06-11	Issued for DP Draft
B	2025-07-11	Issued for DP
C	2025-12-11	Reissued for DP

Professional Seal

**eta** landscape architecture

1690 West 2nd Avenue  
Vancouver , BC , Canada , V6J 1H4

t | 604.683.1456  
f | 604.683.1459  
w | www.etalala.ca

All Rights Reserved by eta landscape architecture inc.  
Information contained on these documents is part of the Consultant's instruments of service, and the Consultant shall retain ownership thereof. Such information shall not be used for any purpose other than for the construction of the referenced project. Any other use, reuse or modification of the documents without the Consultant's prior written consent will be at the recipient's sole risk and without liability or legal exposure to the Consultant.

Project

**Victoria Porsche**

202 Harbour Rd, Victoria, BC, V9A 3S2

Drawing Title

**Landscape Site  
Furnishing Details**

Legal

Project Manager	Project ID
Project Manager	#####
Drawn By	Scale
Drawn By	As Noted
Reviewed By	Drawing No.
Reviewed By	<b>L9.4</b>
	22
	of
	30

1 CUTSHEET: Bike Rack

2 CUTSHEET: Moveable tables

3 CUTSHEET: Timber Top Seats

4 PRECEDENT: Custom Seating Element



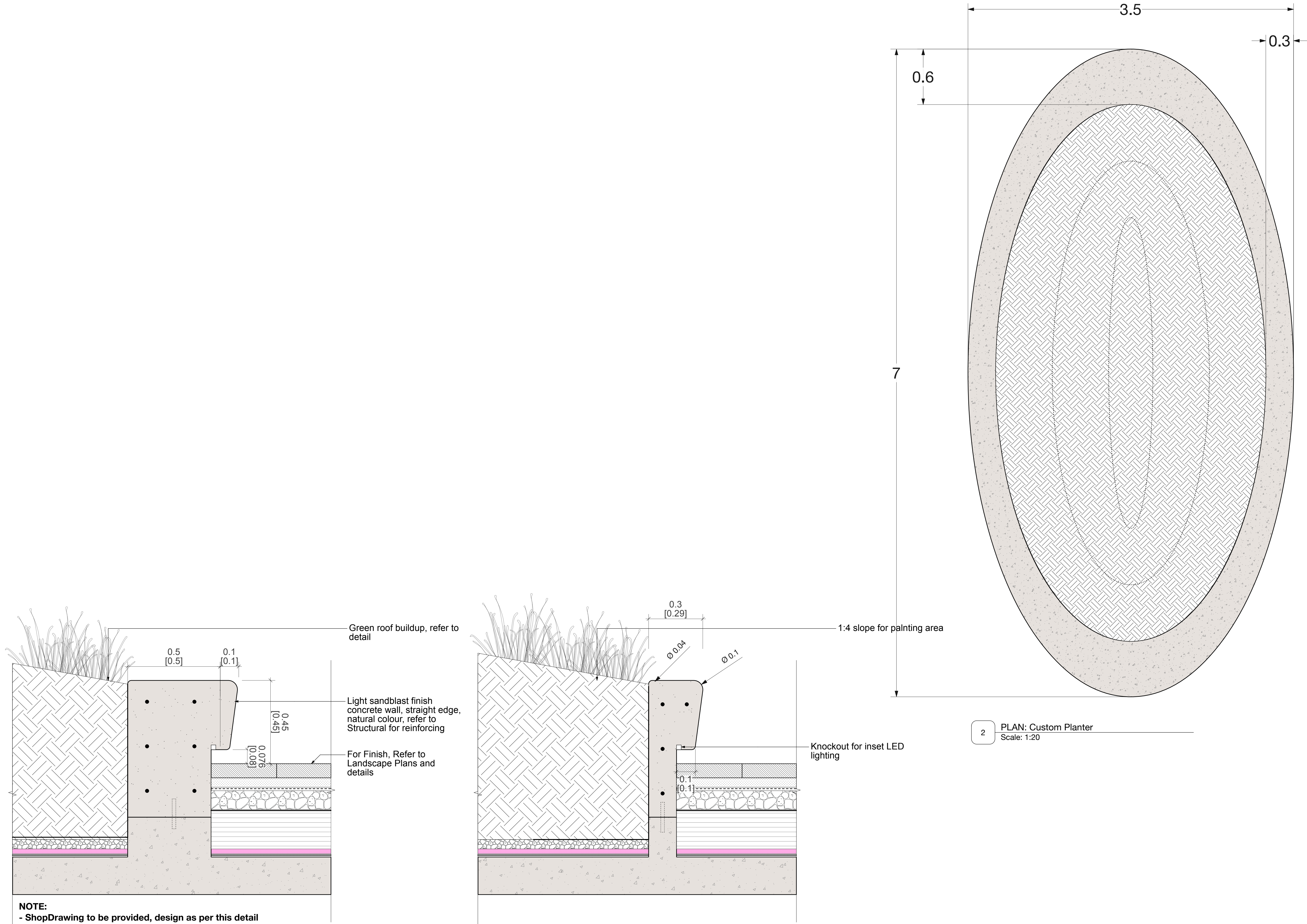



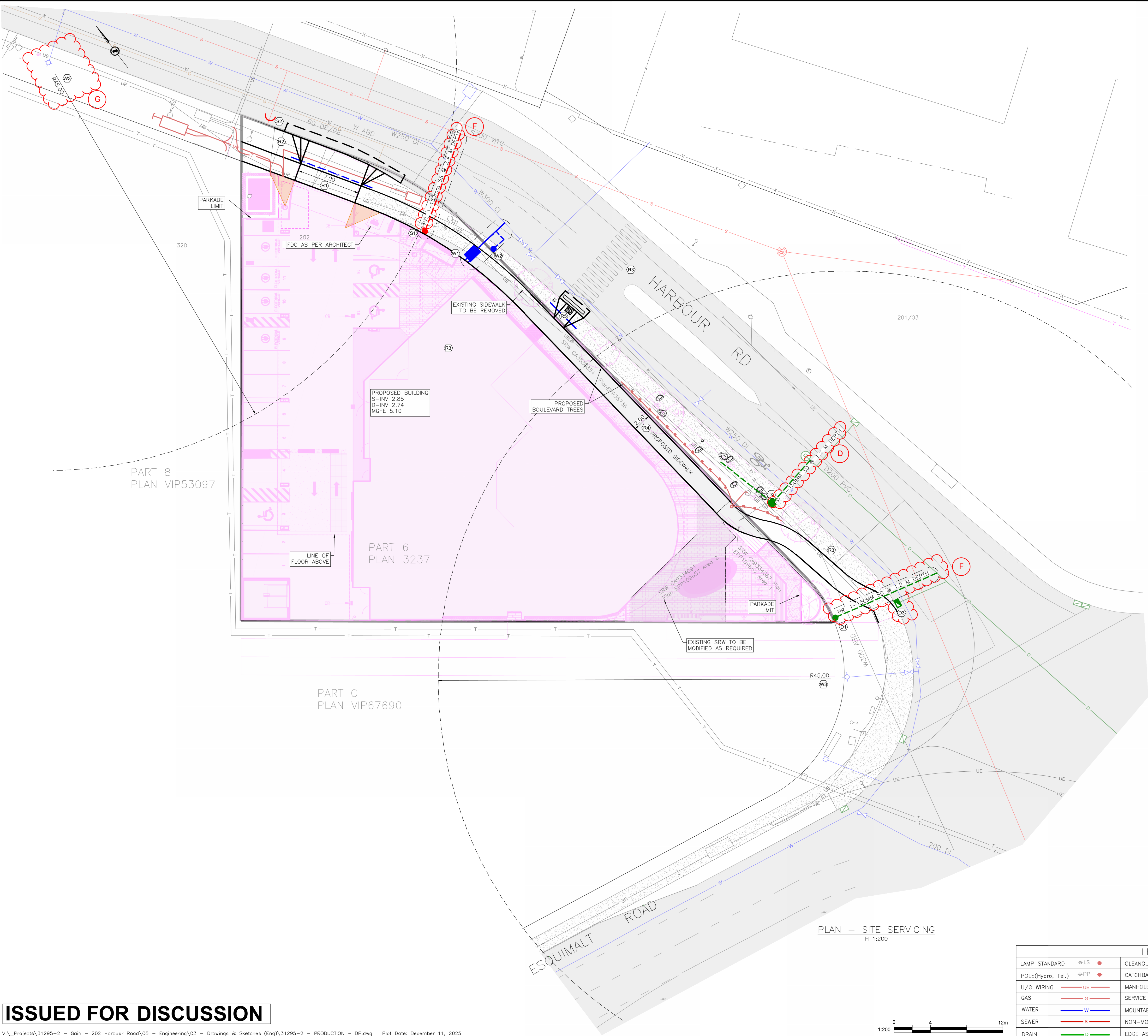

- SHEET NOTES:**
- WATER:**
- (W1) CITY OF VICTORIA TO INSTALL 50 MM DOMESTIC WATER AND 150 MM FIRE SERVICE TO PROPERTY LINE AT DEVELOPERS EXPENSE. DETAILS TO BE CONFIRMED AT BUILDING PERMIT.
  - (W2) CITY OF VICTORIA TO INSTALL 25mm IRRIGATION SERVICE AT DEVELOPERS EXPENSE. DETAILS TO BE CONFIRMED AT BUILDING PERMIT.
  - (W3) 45m FIRE HYDRANT RADIUS.
- DRAIN:**
- (D1) CITY OF VICTORIA TO INSTALL 150mm STORM SERVICE TO PROPERTY LINE AT DEVELOPERS EXPENSE. DETAILS TO BE CONFIRMED AT BUILDING PERMIT.
  - (D2) PROPOSED 150mm DRAIN SERVICE TO RAIN GARDEN. DETAILS TO BE CONFIRMED AT BUILDING PERMIT.
  - (D3) CONTRACTOR TO REMOVE EXISTING CATCH BASIN AND INSTALL NEW SIDE INLET CATCH BASIN AS PER CITY OF VICTORIA STANDARD DETAIL S11B. DETAILS TO BE CONFIRMED AT BUILDING PERMIT.
- SEWER:**
- (S1) CITY OF VICTORIA TO INSTALL 150mm SANITARY SERVICE TO PROPERTY LINE AT DEVELOPERS EXPENSE. DETAILS TO BE CONFIRMED AT BUILDING PERMIT.
  - (S2) CONTRACTOR TO CAP EXISTING SERVICES AS REQUIRED.
- ROAD:**
- (R1) CONTRACTOR TO INSTALL 7.0m DRIVEWAY TO CITY OF VICTORIA STANDARDS.
  - (R2) CONTRACTOR TO REMOVE EXISTING DRIVEWAY AND REINSTATE BOULEVARD AND SIDEWALK AS REQUIRED. DETAILS AT BUILDING PERMIT.
  - (R3) CONTRACTOR TO REMOVE EXISTING SIDEWALK AS REQUIRED AND CONSTRUCT BOULEVARD AND TREES AS PER LANDSCAPE PLAN.
  - (R4) CONTRACTOR TO INSTALL 2.0m SIDEWALK AS REQUIRED.
  - (R5) CONTRACTOR TO INSTALL SIDEWALK LENS DOWN. FUTURE RECTANGULAR RAPID FLASHING BEACON. BUILDING PERMIT SUBMISSION TO INCORPORATE CONDUIT AND SIGN BASE.



KEY PLAN  
NTS

LEGAL DESCRIPTION: THAT PART OF SUB-LOT 6, SECTION 119, ESQUIMALT DISTRICT, PLAN 3237, SHOWN OUTLINED IN RED ON PLAN 1338 OS

BENCHMARK: MONUMENT DERIVED FROM OBSERVATION BETWEEN 739144 AND 931915

202 HARBOUR ROAD  
PRELIMINARY SERVICING  
PLAN

Scale  
horiz. 1:200 Scale  
vert. N/A  
Sheet 1 of 1

Eng. Project No. 31295 - 2

**J E A** J E ANDERSON &  
ASSOCIATES

SURVEYORS - ENGINEERS  
VICTORIA NANAIMO PARKSVILLE CAMPBELL RIVER  
PHONE: 250-727-2214 info@jeanderson.com

ISSUED FOR DISCUSSION